

Gold Coin

NAME

OLD NAMES

T

R

S

Baker

COUNTY

Greenhorn

AREA

high

ELEVATION

ROAD OR HIGHWAY

DISTANCE TO SHIPPING POINT

PRESENT LEGAL OWNER (S)

Mrs. T. J. Sheehy

Clarence Merritt

Willis Walk

OPERATOR

Name of claims

Area

Pat.

Unpat.

4 claims

x

EQUIPMENT ON PROPERTY

Gold

PRINCIPAL ORE

MINOR MINERALS

PUBLISHED REFERENCES

Oregon Metal Mines Handbook 14A pg. 54

MISCELLANEOUS RECORDS

Address

Baker, Ore.

" "

" "

Name of claims

Area

Pat.

Unpat.

6/30/38

- 1) Gold Coin
- 2) Wm. B. ~~W~~lick, Whitney, Oregon
- 3) On Greenham Ch, 2 m. SE of Greenham - NE 1/4 Sec. 15 - T10S - R35E
- 4) Two unpat. lode claims.
- 5) Owned for 17 years, trying to open up ledge.
May 4, 1901 Was operated over 30 years ago.
- 7) Has not been in operation for years except
assessment work.

Hanging wall massive blue shaly argillite, strikes N25°W,
dips 50° E.

Ore from crossings sheared
quartz in blue argillite.

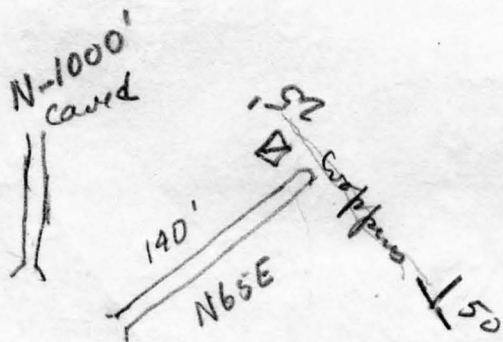

100' = 1''

#2
Sp. from here, also
from Bear Creek,
1 m. E.

Klein says
wildcat.