

MIST GAS FIELD

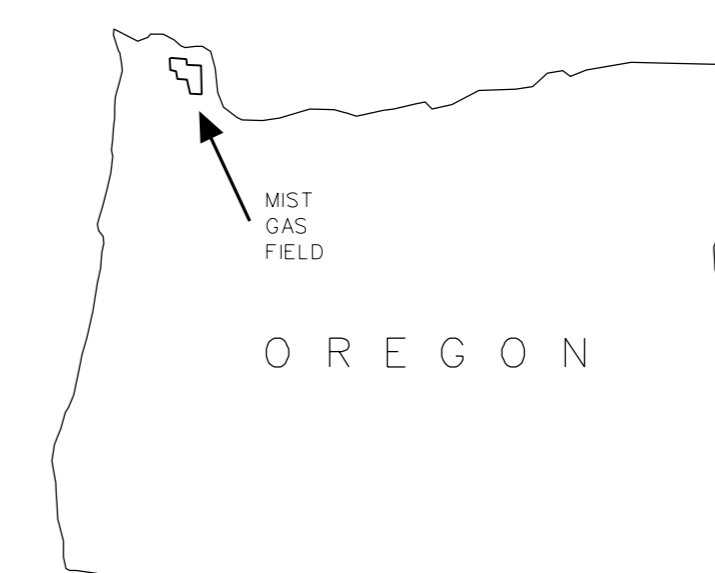

LOCATION MAP

T 7 N
T 6 N

T 7 N
T 6 N

R 4 W

R 4 W

CLATSOP COUNTY
COLUMBIA COUNTY

46° 00'

Oregon State Plane Coordinate System
North-Tier

850,000 FEET

T 6 N
T 5 N

D. Y. ON FOREST CAV 13-6
1796, 1891

D. Y. ON LAKE 24-5-A
1826, 1891

D. Y. ON LAKE 24-5
1473, 1891

MAP SYMBOLS

- WELL LOCATION
- ⊕ NEVER PRODUCED, GAS - SHUT IN OR SUSPENDED
- ☼ GAS PRODUCER
- ⊕ FORMER PRODUCER, GAS - SHUT IN OR SUSPENDED
- ⊕ FORMER PRODUCER, GAS - ABANDONED
- ⊕ DRY HOLE
- ☼ FORMER PRODUCER, GAS - WATER DISPOSAL WELL
- ☼ FORMER WATER DISPOSAL WELL - SHUT IN OR SUSPENDED
- ☼ FORMER PRODUCER - OBSERVATION WELL
- ⊕+ OBSERVATION WELL
- ⊕ GAS INJECTION/WITHDRAWAL WELL
- ⊕+ DIRECTIONAL HOLE - R.D. = REDRILL DEPTH
- ▭ FLORA/BRUER NATURAL GAS STORAGE PROJECT
- ▭ CALVIN CREEK NATURAL GAS STORAGE PROJECT

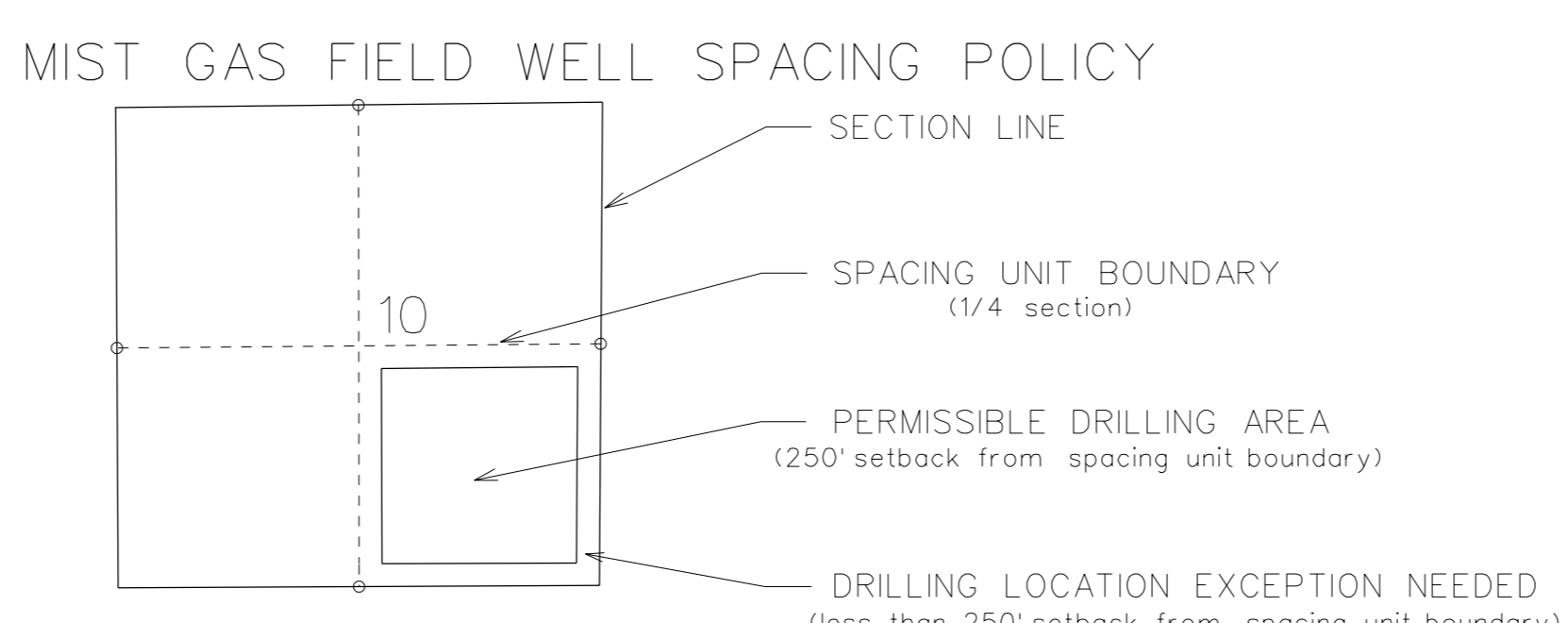

SCALE 1:24,000

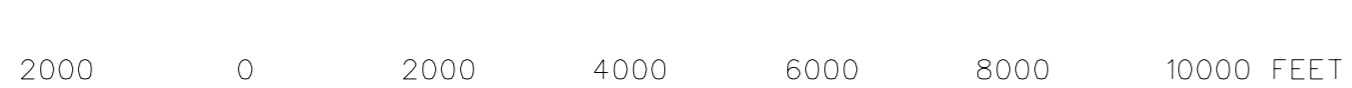

LATEST REVISION: February, 2001

T 5 N

R 5 W R 4 W

Pittsburg

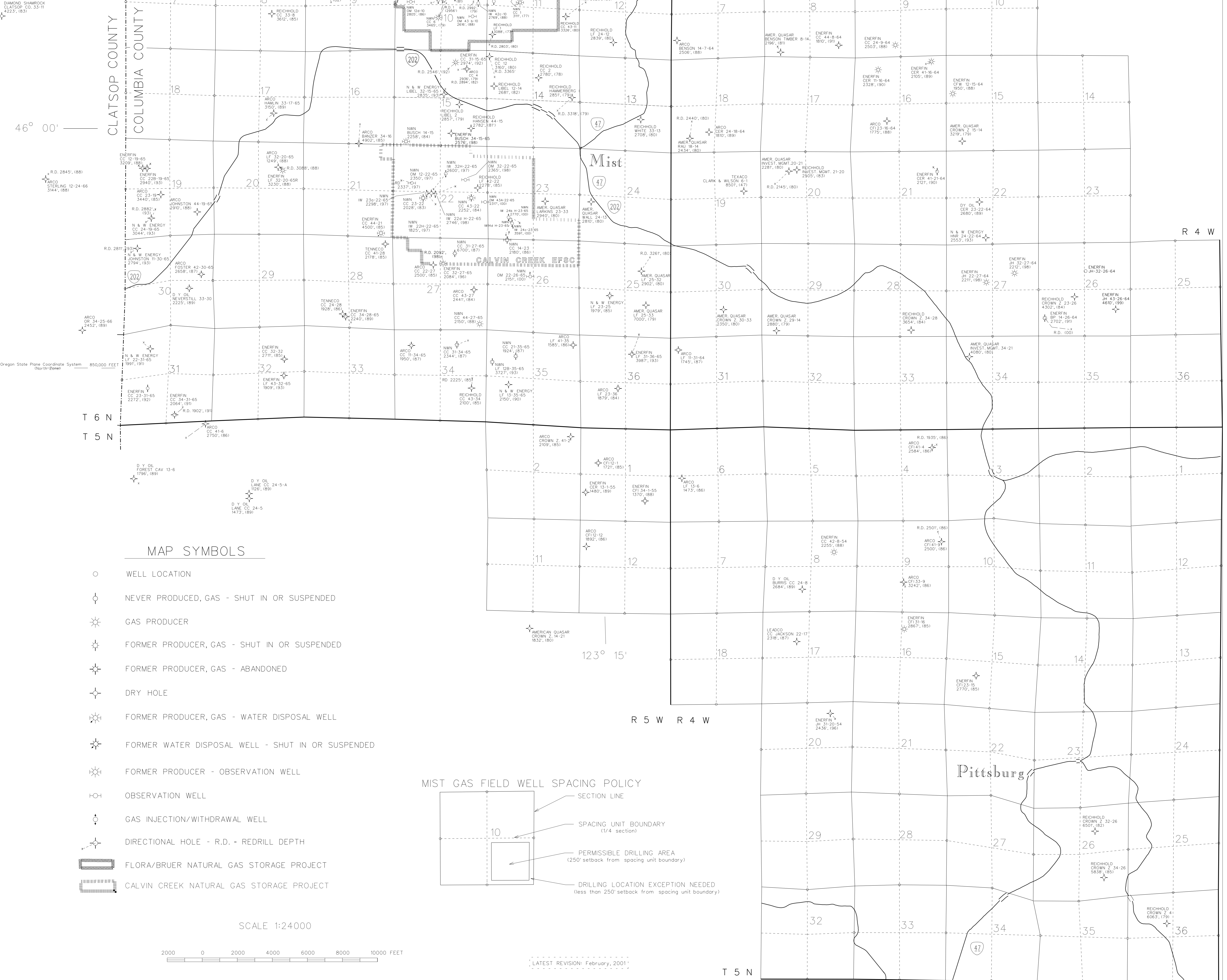

STATE OF OREGON
DEPARTMENT OF GEOLOGY AND MINERAL INDUSTRIES
Suite 965
800 N.E. Oregon Street # 28
Portland, Oregon 97232

Mist Gas Field Production Figures 1993–2000*

Supplement to
Open-File Report O-01-1
Mist Gas Field Map 2001

2001

* Production figures for 1979–1992 are available as Open-File Report O-94-06

**Mist Gas Field
Production Figures
1993**

Production		1993												Year Totals	Production
1993		Jan	Feb	Mar	Apr	May	Jun	Jul	Aug	Sep	Oct	Nov	Dec	Year Totals	1993
Nahama and Weagant	Mcf	17,685	16,505	18,763	16,565	21,699	21,757	21,817	20,958	18,294	18,688	13,310	13,523	219,564	Mcf
CER 11-16-64	Cum. Mcf	345,310	361,815	380,578	397,143	418,842	440,599	462,416	483,374	501,668	520,356	533,666	547,189	547,189	Cum. Mcf
O&G: 449	Tbg pres	281	274	276	276	267	267	266	267	267	264	250	255		Tbg pres
	Csg pres	282	284	281	281	275	270	269	270	267	266	265	265		Csg pres
	Therms	155,803	145,409	165,297	145,934	191,172	191,682	192,206	184,644	161,169	164,644	117,264	119,140	1,934,364	Therms
	Cum. Therms	3,050,483	3,195,892	3,361,189	3,507,123	3,698,295	3,889,977	4,082,183	4,266,827	4,427,996	4,592,640	4,709,904	4,829,044	4,829,044	Cum. Therms
	Btu/cf	881	881	881	881	881	881	881	881	881	881	881	881		Btu/cf
	Days Prod	31	28	31	30	31	30	31	31	30	31	30	29	363 Days Prod	
Nahama and Weagant	Mcf	32,393	24,671	34,314	30,197	38,376	38,299	38,391	37,184	33,007	34,141	31,834	28,326	401,133	Mcf
CER 41-16	Cum. Mcf	712,083	736,754	771,068	801,265	839,641	877,940	916,331	953,515	986,522	1,020,663	1,052,497	1,080,823	1,080,823	Cum. Mcf
O&G: 423	Tbg pres	-----	-----	-----	-----	-----	-----	-----	-----	-----	-----	-----	-----		Tbg pres
	Csg pres	285	284	284	283	275	281	270	271	271	265	265	266		Csg pres
	Therms	283,760	216,120	300,593	264,529	336,170	335,498	336,305	325,732	289,804	299,750	279,503	248,703	3,516,467	Therms
	Cum. Therms	6,232,164	6,448,284	6,748,877	7,013,406	7,349,576	7,685,074	8,021,379	8,347,111	8,636,915	8,936,665	9,216,168	9,464,871	9,464,871	Cum. Therms
	Btu/cf	876	876	876	876	876	876	876	876	878	878	878	878		Btu/cf
	Days Prod	31	25	31	30	31	30	31	31	30	31	30	29	360 Days Prod	
Nahama and Weagant	Mcf	21,945	20,428	22,261	19,294	24,619	23,696	23,953	23,821	21,039	22,156	23,251	20,601	267,064	Mcf
CFW 12-15	Cum. Mcf	533,736	554,164	576,425	595,719	620,338	644,034	667,987	691,808	712,847	735,003	758,254	778,855	778,855	Cum. Mcf
O&G: 408	Tbg pres	-----	-----	-----	-----	-----	-----	-----	-----	-----	-----	-----	-----		Tbg pres
	Csg pres	284	283	281	280	271	275	269	272	268	265	261	263		Csg pres
	Therms	189,822	176,700	192,559	166,896	217,634	205,915	208,151	212,957	191,660	201,839	211,812	187,672	2,363,617	Therms
	Cum. Therms	4,626,500	4,803,200	4,995,759	5,162,655	5,380,289	5,586,204	5,794,355	6,007,312	6,198,972	6,400,811	6,612,623	6,800,295	6,800,295	Cum. Therms
	Btu/cf	865	865	865	865	884	869	869	894	911	911	911	911		Btu/cf
	Days Prod	31	28	31	30	31	30	31	31	30	31	30	29	363 Days Prod	
Nahama and Weagant	Mcf	8,152	6,858	7,238	6,602	6,383	6,735	0	SHUT IN					41,968	Mcf
Columbia County 12-19	Cum. Mcf	666,782	673,640	680,878	687,480	693,863	700,598	700,598						700,598	Cum. Mcf
O&G: 400	Tbg pres	88	87	92	91	90	96	-----							Tbg pres
	Csg pres	275	276	278	275	342	381	-----							Csg pres
	Therms	81,278	68,380	72,165	65,823	63,638	67,141	0						418,425	Therms
	Cum. Therms	6,594,776	6,663,156	6,735,321	6,801,144	6,864,782	6,931,923	6,931,923						6,931,923	Cum. Therms
	Btu/cf	997	997	997	997	997	997	-----							Btu/cf
	Days Prod	31	28	31	30	28	28	0						176 Days Prod	
Nahama and Weagant	Mcf	25,401	21,928	21,750	15,060	24,483	24,195	23,275	22,770	20,263	17,075	15,573	13,932	245,705	Mcf
Columbia County 13-34	Cum. Mcf	3,522,802	3,544,730	3,566,480	3,581,540	3,606,023	3,630,218	3,653,493	3,676,263	3,696,526	3,713,601	3,729,174	3,743,106	3,743,106	Cum. Mcf
O&G: 225	Tbg pres	318	308	245	269	273	272	275	262	238	235	230	233		Tbg pres
	Csg pres	329	320	236	283	291	282	293	272	270	260	239	245		Csg pres
	Therms	251,208	216,870	215,109	148,951	242,137	239,289	230,185	225,200	200,404	168,872	154,012	137,788	2,430,025	Therms
	Cum. Therms	33,727,709	33,944,579	34,159,688	34,308,639	34,550,776	34,790,065	35,020,250	35,245,450	35,445,854	35,614,726	35,768,738	35,906,526	35,906,526	Cum. Therms
	Btu/cf	989	989	989	989	989	989	989	989	989	989	989	989		Btu/cf
	Days Prod	31	28	31	30	31	30	31	31	30	31	30	29	363 Days Prod	

		Production												Production		
		1993	Jan	Feb	Mar	Apr	May	Jun	Jul	Aug	Sept	Oct	Nov	Dec	Year Totals	1993
Nahama and Weagant	Mcf		30,374	30,424	40,402	45,833	50,278	48,032	47,786	46,484	43,830	45,820	40,921	38,638	508,822	Mcf
Columbia County 14-23	Cum. Mcf	4,216,186	4,246,610	4,287,012	4,332,845	4,383,123	4,431,155	4,478,941	4,525,425	4,569,255	4,615,075	4,655,996	4,694,634	4,694,634	4,694,634	Cum. Mcf
O&G: 318	Tbg pres	235	230	200	195	188	187	180	181	174	168	168	161	161		Tbg pres
	Csg pres	241	236	225	224	214	210	205	204	194	190	190	185	185		Csg pres
	Therms	294,122	291,156	386,643	438,622	481,156	459,665	457,314	444,853	419,457	438,500	391,616	369,765	4,872,869	4,872,869	Therms
	Cum. Therms	39,769,539	40,060,695	40,447,338	40,885,960	41,367,116	41,826,781	42,284,095	42,728,948	43,148,405	43,586,905	43,978,521	44,348,286	44,348,286	44,348,286	Cum. Therms
	Btu/cf	957	957	957	957	957	957	957	957	957	957	957	957	957		Btu/cf
	Days Prod		31	28	31	30	31	30	31	31	30	31	30	29	363	Days Prod
Nahama and Weagant	Mcf	7,881	8,854	10,761	9,712	12,618	12,724	14,597	13,728	13,417	12,275	12,103	9,552	138,222	138,222	Mcf
Columbia County 21-35	Cum. Mcf	315,515	324,369	335,130	344,842	357,460	370,184	384,781	398,509	411,926	424,201	436,304	445,856	445,856	445,856	Cum. Mcf
O&G: 393	Tbg pres	367	331	331	327	340	304	300	302	294	292	250	256	256		Tbg pres
	Csg pres	431	396	395	351	347	312	307	311	306	311	268	270	270		Csg pres
	Therms	71,004	79,774	96,957	87,505	113,693	114,647	131,517	123,831	121,027	110,725	109,167	86,158	1,246,005	1,246,005	Therms
	Cum. Therms	2,799,110	2,878,884	2,975,841	3,063,346	3,177,039	3,291,686	3,423,203	3,547,034	3,668,061	3,778,786	3,887,953	3,974,111	3,974,111	3,974,111	Cum. Therms
	Btu/cf	901	901	901	901	901	901	901	902	902	902	902	902	902		Btu/cf
	Days Prod		31	28	31	28	31	30	31	31	30	31	30	29	361	Days Prod
Nahama and Weagant	Mcf									33,649	33,036	35,711	32,757	135,153	135,153	Mcf
Columbia Co. 22B-19	Cum. Mcf									33,649	66,685	102,396	135,153	66,685	66,685	Cum. Mcf
O&G: 481	Tbg pres									775	735	674	600	600		Tbg pres
	Csg pres									785	785	683	624	624		Csg pres
	Therms									335,817	329,701	356,395	326,912	1,348,825	1,348,825	Therms
	Cum. Therms									335,817	665,518	1,021,913	1,348,825	665,518	665,518	Cum. Therms
	Btu/cf									998	998	998	998	998		Btu/cf
	Days Prod									29	31	30	29	119	119	Days Prod
Nahama and Weagant	Mcf	8,342	9,924	12,447	11,290	11,894	11,223	9,294	12,382	11,314	10,750	9,690	8,257	126,807	126,807	Mcf
Columbia County 23-22	Cum. Mcf	5,311,314	5,321,238	5,333,685	5,344,975	5,356,869	5,368,092	5,377,386	5,389,768	5,401,082	5,411,832	5,421,522	5,429,779	5,429,779	5,429,779	Cum. Mcf
O&G: 237	Tbg pres	63	61	61	60	56	51	50	45	44	43	42	42	42		Tbg pres
	Csg pres	75	65	65	65	60	60	55	52	51	45	46	46	46		Csg pres
	Therms	82,170	97,749	122,600	111,204	117,034	110,437	91,455	121,846	111,334	105,780	95,350	81,245	1,248,204	1,248,204	Therms
	Cum. Therms	48,938,801	49,036,550	49,159,150	49,270,354	49,387,388	49,497,825	49,589,280	49,711,126	49,822,460	49,928,240	50,023,590	50,104,835	50,104,835	50,104,835	Cum. Therms
	Btu/cf	985	985	985	985	984	984	984	984	984	984	984	984	984		Btu/cf
	Days Prod	21	26	30	30	31	30	26	31	30	31	30	29	345	345	Days Prod
Nahama and Weagant	Mcf	12,935	12,365	10,308	13,665	14,003	11,109	13,356	13,580	12,818	13,527	10,693	13,883	152,242	152,242	Mcf
Columbia County 24-9	Cum. Mcf	294,208	306,573	316,881	330,546	344,549	355,658	369,014	382,594	395,412	408,939	419,632	433,515	433,515	433,515	Cum. Mcf
O&G: 407	Tbg pres	-----	-----	-----	-----	-----	-----	-----	-----	-----	-----	-----	-----	-----		Tbg pres
	Csg pres	269	270	271	268	256	257	250	260	256	251	248	255	255		Csg pres
	Therms	113,437	108,562	90,505	119,974	122,948	97,540	117,262	119,228	112,799	119,039	94,101	122,171	1,337,566	1,337,566	Therms
	Cum. Therms	2,569,884	2,678,446	2,768,951	2,888,925	3,011,873	3,109,413	3,226,675	3,345,903	3,458,702	3,577,741	3,671,842	3,794,013	3,794,013	3,794,013	Cum. Therms
	Btu/cf	877	878	878	878	878	878	878	878	880	880	880	880	880		Btu/cf
	Days Prod		30	28	31	30	31	30	31	31	30	31	30	28	361	Days Prod

		Production												Production		
		1993	Jan	Feb	Mar	Apr	May	Jun	Jul	Aug	Sept	Oct	Nov	Dec	Year Totals	1993
Nahama and Weagant	Mcf		47,833	44,391	50,859	48,343	49,878	50,121	49,004	47,842	35,441	24,401	10,417	8,313	466,843	Mcf
Columbia County 31-15	Cum. Mcf		59,894	104,285	155,144	203,487	253,365	303,486	352,490	400,332	435,773	460,174	470,591	478,904	478,904	Cum. Mcf
O&G: 469	Tbg pres		676	633	578	520	462	390	317	262	246	238	230	230		Tbg pres
	Csg pres		689	646	594	538	481	414	347	289	259	248	240	236		Csg pres
	Therms		466,275	414,166	474,510	451,042	465,363	467,629	457,209	447,795	331,734	228,298	97,503	77,812	4,379,336	Therms
	Cum. Therms		578,807	992,973	1,467,483	1,918,525	2,383,888	2,851,517	3,308,726	3,756,521	4,088,255	4,316,553	4,414,056	4,491,868	4,491,868	Cum. Therms
	Btu/cf		933	933	933	933	933	933	933	936	936	936	936	936		Btu/cf
	Days Prod		31	28	31	30	31	30	31	31	30	31	30	29	363 Days Prod	
Nahama and Weagant	Mcf		1,898	3,766	3,819	2,996	3,192	2,887	2,698	2,560	2,406	2,383	2,132	861	31,598	Mcf
Columbia County 31-34	Cum. Mcf		1,210,290	1,214,056	1,217,875	1,220,871	1,224,063	1,226,950	1,229,648	1,232,208	1,234,614	1,236,997	1,239,129	1,239,990	1,239,990	Cum. Mcf
O&G: 386	Tbg pres		17	11	11	9	9	9	5	6	5	4	3	4		Tbg pres
	Csg pres		21	15	14	10	10	11	7	8	6	5	4	5		Csg pres
	Therms		17,476	34,688	35,177	27,595	29,394	26,588	24,849	23,579	22,181	21,973	19,654	7,933	291,087	Therms
	Cum. Therms		10,948,327	10,983,015	11,018,192	11,045,787	11,075,181	11,101,769	11,126,618	11,150,197	11,172,378	11,194,351	11,214,005	11,221,938	11,221,938	Cum. Therms
	Btu/cf		921	921	921	921	921	921	921	921	922	922	922	922		Btu/cf
	Days Prod		16	28	31	29	31	30	31	31	30	31	30	14	332 Days Prod	
Nahama and Weagant	Mcf		7,328	6,664	7,424	6,286	6,849	6,304	6,332	5,971	5,724	5,254	580	SHUT IN	64,716	Mcf
Columbia County 32-32	Cum. Mcf		1,352,616	1,359,280	1,366,704	1,372,990	1,379,839	1,386,143	1,392,475	1,398,446	1,404,170	1,409,424	1,410,004		1,410,004	Cum. Mcf
O&G: 339	Tbg pres		46	45	45	45	36	37	36	35	30	492			Tbg pres	
	Csg pres		135	131	132	112	136	137	136	142	137	145	494			Csg pres
	Therms		71,307	64,843	72,236	61,161	66,634	61,274	61,544	58,041	55,638	51,073	5,636		629,387	Therms
	Cum. Therms		12,955,358	13,020,201	13,092,437	13,153,598	13,220,232	13,281,506	13,343,050	13,401,091	13,456,729	13,507,802	13,513,438		13,513,438	Cum. Therms
	Btu/cf		973	973	973	973	973	972	972	972	972	972	972			Btu/cf
	Days Prod		31	28	31	30	31	30	31	31	30	31	6		310 Days Prod	
Nahama and Weagant	Mcf		37,486	36,050	40,376	38,960	47,127	43,966	44,141	53,735	49,890	52,352	48,075	45,470	537,628	Mcf
Columbia County 43-33	Cum. Mcf		162,696	198,746	239,122	278,082	325,209	369,175	413,316	467,051	516,941	569,293	617,368	662,838	662,838	Cum. Mcf
O&G: 470	Tbg pres		352	340	330	312	298	288	285	250	212	203	198	187		Tbg pres
	Csg pres		369	358	350	335	320	314	305	281	260	251	241	232		Csg pres
	Therms		370,359	356,172	398,912	384,926	465,611	434,377	436,116	530,902	492,915	517,238	474,978	449,244	5,311,750	Therms
	Cum. Therms		1,607,427	1,963,599	2,362,511	2,747,437	3,213,048	3,647,425	4,083,541	4,614,443	5,107,358	5,624,596	6,099,574	6,548,818	6,548,818	Cum. Therms
	Btu/cf		988	988	988	988	988	988	988	988	988	988	988	988		Btu/cf
	Days Prod		31	28	31	30	31	30	31	31	30	31	30	29	363 Days Prod	
Nahama and Weagant	Mcf		4,773	3,780	3,381	4,246	4,823	3,553	2,770	2,744	3,207	3,357	3,204	3,194	43,032	Mcf
Columbia County 44-8	Cum. Mcf		47,635	51,415	54,796	59,042	63,865	67,418	70,188	72,932	76,139	79,496	82,700	85,894	85,894	Cum. Mcf
O&G: 459	Tbg pres		271	272	275	271	261	262	258	260	262	256	250	255		Tbg pres
	Csg pres		281	275	275	271	267	272	266	266	265	260	260	260		Csg pres
	Therms		42,913	33,940	30,361	38,125	43,358	31,937	24,904	24,671	28,864	30,219	28,833	28,745	386,870	Therms
	Cum. Therms		428,717	462,657	493,018	531,143	574,501	606,438	631,342	656,013	684,877	715,096	743,929	772,674	772,674	Cum. Therms
	Btu/cf		899	898	898	898	899	899	899	899	900	900	900	900		Btu/cf
	Days Prod		31	28	31	30	31	30	31	31	30	31	30	29	363 Days Prod	

		Production												Production		
		1993	Jan	Feb	Mar	Apr	May	Jun	Jul	Aug	Sept	Oct	Nov	Dec	Year Totals	1993
Nahama and Weagant	Mcf		5,761	280	1,884	4,900	7,034	6,908	6,744	4,782	0	3,151	8,485	8,708	58,637	Mcf
Columbia County 44-27	Cum. Mcf	631,137	631,417	633,301	638,201	645,235	652,143	658,887	663,669	663,669	666,820	675,305	684,013	684,013	684,013	Cum. Mcf
O&G: 406	Tbg pres		50	26								65	62	57		Tbg pres
	Csg pres		175		15	56	46	50	40	44		123	120	115		Csg pres
	Therms		53,175	2,587	17,385	45,220	64,992	63,827	62,309	44,192	0	29,115	78,398	80,457	541,657	Therms
	Cum. Therms	5,694,069	5,696,656	5,714,041	5,759,261	5,824,253	5,888,080	5,950,389	5,994,581	5,994,581	6,023,696	6,102,094	6,182,551	6,182,551	6,182,551	Cum. Therms
	Btu/cf		923	923	923	923	924	924	924	924	924	924	924	924		Btu/cf
	Days Prod		31	2	11	24	31	30	31	24	0	12	30	31	257	Days Prod
Nahama and Weagant	Mcf							11,699	31,830	31,435	32,125	31,577	29,933	168,599		Mcf
LF 12A-33	Cum. Mcf							11,699	43,529	74,964	107,089	138,666	168,599	544,546		Cum. Mcf
O&G: 474	Tbg pres							480	439	415	386	380	372			Tbg pres
	Csg pres							240	230	239	235	230	236			Csg pres
	Therms							116,635	318,614	314,665	321,574	316,080	299,622	1,687,190		Therms
	Cum. Therms							116,635	435,249	749,914	1,071,488	1,387,568	1,687,190	3,374,380		Cum. Therms
	Btu/cf							997	1,001	1,001	1,001	1,001	1,001			Btu/cf
	Days Prod							12	31	30	31	30	30		164	Days Prod
Nahama and Weagant	Mcf								11,454	37,364	47,823	45,641	47,720	190,002		Mcf
Longview Fibre 12B-35-	Cum. Mcf								11,454	48,818	96,641	142,282	190,002	380,004		Cum. Mcf
O&G: 476	Tbg pres								530	494	486	470	448			Tbg pres
	Csg pres								535	507	501	485	467			Csg pres
	Therms								102,972	348,238	445,710	425,372	444,746	1,767,038		Therms
	Cum. Therms								102,972	451,210	896,920	1,322,292	1,767,038	3,534,076		Cum. Therms
	Btu/cf								899	932	932	932	932			Btu/cf
	Days Prod								12	30	31	30	30		133	Days Prod
Nahama and Weagant	Mcf										12,040	14,202	10,815	37,057		Mcf
Longview Fibre 31-36	Cum. Mcf										12,040	26,242	37,057	37,057		Cum. Mcf
O&G: 478	Tbg pres										293	270	240			Tbg pres
	Csg pres										295	270	249			Csg pres
	Therms										109,201	128,813	98,091	336,105		Therms
	Cum. Therms										109,201	238,014	336,105	336,105		Cum. Therms
	Btu/cf										907	907	907			Btu/cf
	Days Prod										26	30	29		85	Days Prod
Nahama and Weagant	Mcf		4,028	2,458	5,803	4,853	4,670	4,409	4,267	4,093	3,460	3,790	3,637	3,293	48,761	Mcf
Longview Fibre 32-20	Cum. Mcf		293,165	295,623	301,426	306,279	310,949	315,358	319,625	323,718	327,178	330,968	334,605	337,898	337,898	Cum. Mcf
O&G: 412	Tbg pres															Tbg pres
	Csg pres		133	136	115	120	116	232	240	240	238	250	259	256		Csg pres
	Therms		40,001	24,407	57,621	48,185	46,373	43,781	42,368	40,646	34,454	37,638	36,118	32,695	484,287	Therms
	Cum. Therms		2,893,948	2,918,355	2,975,976	3,024,161	3,070,534	3,114,315	3,156,683	3,197,329	3,231,783	3,269,421	3,305,539	3,338,234	3,338,234	Cum. Therms
	Btu/cf		993	993	993	993	993	993	993	993	993	993	993	993		Btu/cf
	Days Prod		31	19	31	30	31	30	31	31	30	31	30	30	355	Days Prod

**Mist Gas Field
Production Figures
1994**

		Production												Production	
1994		Jan	Feb	Mar	Apr	May	Jun	Jul	Aug	Sep	Oct	Nov	Dec	Year Totals	1994
Nahama and Weagant	Mcf	14,833	19,787	13,797	18,069	28,780	28,326	28,388	26,482	21,684	18,811	13,333	22,924	255,214	Mcf
CER 11-16-64	Cum. Mcf	562,022	581,809	595,606	613,675	642,455	670,781	699,169	725,651	747,335	766,146	779,479	802,403	802,403	Cum. Mcf
O&G: 449	Tbg pres	248	253	260	256	235	231	232	232	230	225	232	228		Tbg pres
	Csg pres	255	262	265	260	245	241	242	241	239	235	242	237		Csg pres
	Therms	130,676	174,321	122,795	160,816	256,142	252,095	252,649	235,685	192,116	166,664	118,133	203,109	2,265,201	Therms
	Cum. Therms	4,959,720	5,134,041	5,256,836	5,417,652	5,673,794	5,925,889	6,178,538	6,414,223	6,606,339	6,773,003	6,891,136	7,094,245	7,094,245	Cum. Therms
	Btu/cf	881	881	890	890	890	890	890	890	886	886	886	886	886	Btu/cf
	Days Prod	31	28	22	30	31	30	31	30	30	22	19	31	335	Days Prod
Nahama and Weagant	Mcf	31,242	51,709	35,386	51,318	55,641	47,629	48,588	45,288	37,616	35,568	32,054	40,562	512,601	Mcf
CER 41-16	Cum. Mcf	1,112,065	1,163,774	1,199,160	1,250,478	1,306,119	1,353,748	1,402,336	1,447,624	1,485,240	1,520,808	1,552,862	1,593,424	1,593,424	Cum. Mcf
O&G: 423	Tbg pres	-----	-----	-----	-----	-----	-----	-----	-----	-----	-----	-----	-----		Tbg pres
	Csg pres	262	261	258	250	250	248	248	247	245	240	240	240		Csg pres
	Therms	274,309	453,926	313,487	454,625	492,931	421,945	430,444	401,212	331,027	312,996	282,075	356,944	4,525,921	Therms
	Cum. Therms	9,739,180	10,193,106	10,506,593	10,961,218	11,454,149	11,876,094	12,306,538	12,707,750	13,038,777	13,351,773	13,633,848	13,990,792	13,990,792	Cum. Therms
	Btu/cf	878	878	886	886	886	886	886	886	880	880	880	880	882	Btu/cf
	Days Prod	31	28	22	30	31	30	31	30	30	28	29	31	351	Days Prod
Nahama and Weagant	Mcf							69,868	80,455	31,200	70,038	42,550	54,904	349,015	Mcf
CFI 31-16	Cum. Mcf							69,868	150,323	181,523	251,561	294,111	349,015	349,015	Cum. Mcf
O&G: 307	Tbg pres							769	687	750	648	700	545		Tbg pres
	Csg pres							810	760	760	700	700	655		Csg pres
	Therms							375,192	432,043	167,546	376,101	228,496	294,836	1,874,214	Therms
	Cum. Therms							375,192	807,235	974,781	1,350,882	1,579,378	1,874,214	11,339,085	Cum. Therms
	Btu/cf							537	537	537	537	537	537	537	Btu/cf
	Days Prod							30	29	12	21	17	29	138	Days Prod
Nahama and Weagant	Mcf	22,813	26,725	18,434	26,201	7,889	22,673	22,144	21,864	19,918	17,060	18,597	20,192	244,510	Mcf
CFW 12-15	Cum. Mcf	801,668	828,393	846,827	873,028	880,917	903,590	925,734	947,598	967,516	984,576	1,003,173	1,023,365	1,023,365	Cum. Mcf
O&G: 408	Tbg pres	-----	-----	-----	-----	-----	-----	-----	-----	-----	-----	-----	-----		Tbg pres
	Csg pres	262	243	255	240	250	240	240	240	232	231	233	222		Csg pres
	Therms	207,824	243,461	162,222	230,564	69,422	199,523	194,867	192,395	174,479	149,449	162,911	176,883	2,164,000	Therms
	Cum. Therms	7,008,119	7,251,580	7,413,802	7,644,366	7,713,788	7,913,311	8,108,178	8,300,573	8,475,052	8,624,501	8,787,412	8,964,295	8,964,295	Cum. Therms
	Btu/cf	911	911	880	880	880	880	880	880	876	876	876	876	876	Btu/cf
	Days Prod	31	28	22	30	9	30	31	30	30	27	30	31	329	Days Prod
Nahama and Weagant	Mcf							77,542	66,046	12,198	46,449	34,723	57,933	294,891	Mcf
CFI 23-15	Cum. Mcf							77,542	143,588	155,786	202,235	236,958	294,891	294,891	Cum. Mcf
O&G: 324	Tbg pres							745	622	725	666	638	510		Tbg pres
	Csg pres							788	721	725	666	648	560		Csg pres
	Therms							504,798	429,963	79,407	302,384	226,049	377,147	1,919,748	Therms
	Cum. Therms							504,798	934,761	1,014,168	1,316,552	1,542,601	1,919,748	8,720,043	Cum. Therms
	Btu/cf							651	651	651	651	651	651	651	Btu/cf
	Days Prod							30	29	8	19	16	29	131	Days Prod

		Production												Production		
		1994	Jan	Feb	Mar	Apr	May	Jun	Jul	Aug	Sept	Oct	Nov	Dec	Year Totals	1994
Nahama and Weagant	Mcf		SHUT IN	SHUT IN	SHUT IN	SHUT IN	SHUT IN	SHUT IN	SHUT IN	SHUT IN	SHUT IN	SHUT IN	SHUT IN			Mcf
Columbia County 12-19	Cum. Mcf															Cum. Mcf
O&G: 400	Tbg pres															Tbg pres
	Csg pres															Csg pres
	Therms															Therms
	Cum. Therms															Cum. Therms
	Btu/cf															Btu/cf
	Days Prod															Days Prod
Nahama and Weagant	Mcf		13,411	8,646	12,633	17,061	17,434	16,451	16,708	15,663	14,610	13,410	11,264	12,125	169,416	Mcf
Columbia County 13-34	Cum. Mcf		3,756,817	3,765,463	3,778,096	3,795,157	3,812,591	3,829,042	3,845,750	3,861,413	3,876,023	3,889,433	3,900,697	3,912,822	3,912,822	Cum. Mcf
O&G: 225	Tbg pres		240	243	170	169	175	168	165	161	158	140	147	135		Tbg pres
	Csg pres		250	258	210	188	187	180	175	172	168	170	158	165		Csg pres
	Therms		132,629	85,506	124,724	168,437	172,123	162,417	164,956	154,641	144,495	132,629	111,398	119,909	1,673,864	Therms
	Cum. Therms		36,039,155	36,124,661	36,249,385	36,417,822	36,589,945	36,752,362	36,917,318	37,071,959	37,216,454	37,349,083	37,460,481	37,580,390	37,580,390	Cum. Therms
	Btu/cf		989	989	987	987	987	987	987	987	989	989	989	989	989	Btu/cf
	Days Prod		31	28	22	30	31	30	31	31	31	29	29	31	354	Days Prod
Nahama and Weagant	Mcf		42,121	2,724	SHUT IN	SHUT IN	SHUT IN	SHUT IN	SHUT IN	SHUT IN	SHUT IN	SHUT IN	SHUT IN	SHUT IN	44,845	Mcf
Columbia County 14-23	Cum. Mcf		4,736,755	4,739,479											4,739,479	Cum. Mcf
O&G: 318	Tbg pres		158	229												Tbg pres
	Csg pres		183	221												Csg pres
	Therms		403,094	26,066											429,160	Therms
	Cum. Therms		44,751,380	44,777,446											44,777,446	Cum. Therms
	Btu/cf		957	957											957	Btu/cf
	Days Prod		31	2											33	Days Prod
Nahama and Weagant	Mcf		10,889	9,223	6,421	8,420	7,895	6,515	5,855	4,916	4,690	2,892	2,914	3,076	73,706	Mcf
Columbia County 21-35	Cum. Mcf		456,745	465,968	472,389	480,809	488,704	495,219	501,074	505,990	510,680	513,572	516,486	519,562	519,562	Cum. Mcf
O&G: 393	Tbg pres		255	250	255	244	242	255	265	252	232	229	238	235		Tbg pres
	Csg pres		265	255	268	252	250	265	275	265	255	254	250	250		Csg pres
	Therms		98,220	83,195	58,073	76,147	71,401	58,925	52,953	44,456	42,258	26,053	26,257	27,710	665,648	Therms
	Cum. Therms		4,072,331	4,155,526	4,213,599	4,289,746	4,361,147	4,420,072	4,473,025	4,517,481	4,559,739	4,585,792	4,612,049	4,639,759	4,639,759	Cum. Therms
	Btu/cf		902	902	904	904	904	904	904	904	901	901	901	901	901	Btu/cf
	Days Prod		31	28	22	30	31	30	31	30	30	24	26	31	344	Days Prod
Nahama and Weagant	Mcf		32,267	24,722	24,278	27,968	20,835	14,597	11,189	6,231	4,664	2,935	19	0	169,705	Mcf
Columbia Co. 22B-19	Cum. Mcf		98,952	123,674	147,952	175,920	196,755	211,352	222,541	228,772	233,436	236,371	236,390	236,390	236,390	Cum. Mcf
O&G: 481	Tbg pres		550	537	483	373	299	247	270	270	288	270	265	270		Tbg pres
	Csg pres		581	563	513	432	415	340	341	340	369	365	-----	0		Csg pres
	Therms		322,022	246,728	242,074	278,869	207,749	145,551	111,562	62,126	46,511	29,269	0	0	1,692,461	Therms
	Cum. Therms		987,540	1,234,268	1,476,342	1,755,211	1,962,960	2,108,511	2,220,073	2,282,199	2,328,710	2,357,979	2,357,979	2,357,979	2,357,979	Cum. Therms
	Btu/cf		998	998	997	997	997	997	997	997	997	997	997	997	997	Btu/cf
	Days Prod		31	28	22	30	31	30	31	30	29	29	1	0	292	Days Prod

		Production												Production		
		1994	Jan	Feb	Mar	Apr	May	Jun	Jul	Aug	Sept	Oct	Nov	Dec	Year Totals	1994
Nahama and Weagant	Mcf		8,555	545	SHUT IN	SHUT IN	SHUT IN	SHUT IN	SHUT IN	SHUT IN	SHUT IN	SHUT IN	SHUT IN		9,100	Mcf
Columbia County 23-22	Cum. Mcf		5,438,334	5,438,879											5,438,879	Cum. Mcf
O&G: 237	Tbg pres		40	58												Tbg pres
	Csg pres		44	63												Csg pres
	Therms		84,180	5,359											89,539	Therms
	Cum. Therms		50,189,015	50,194,374											50,194,374	Cum. Therms
	Btu/cf		984	984											984	Btu/cf
	Days Prod		31	2											33	Days Prod
Nahama and Weagant	Mcf		12,256	14,404	9,923	14,087	19,361	18,044	18,776	17,177	15,723	11,617	12,634	17,221	181,223	Mcf
Columbia County 24-9	Cum. Mcf		445,771	460,175	470,098	484,185	503,546	521,590	540,366	557,543	573,266	584,883	597,517	614,738	614,738	Cum. Mcf
O&G: 407	Tbg pres		-----	-----	-----	-----	-----	-----	-----	-----	-----	-----	-----	-----		Tbg pres
	Csg pres		245	257	265	260	235	233	236	235	231	218	243	228		Csg pres
	Therms		107,851	126,755	88,027	124,964	171,747	160,067	166,559	152,377	138,672	102,462	111,435	151,888	1,602,804	Therms
	Cum. Therms		3,901,864	4,028,619	4,116,646	4,241,610	4,413,357	4,573,424	4,739,983	4,892,360	5,031,032	5,133,494	5,244,929	5,396,817	5,396,817	Cum. Therms
	Btu/cf		880	880	887	887	887	887	887	887	882	882	882	882	882	Btu/cf
	Days Prod		31	28	21	30	31	30	31	30	30	21	24	31	338	Days Prod
Nahama and Weagant	Mcf		12,263	17,268	17,977	22,409	18,884	15,759	13,299	12,422	11,128	9,030	7,135	5,919	163,493	Mcf
Columbia County 31-15	Cum. Mcf		491,167	508,435	526,412	548,821	567,705	583,464	596,763	609,185	620,313	629,343	636,478	642,397	642,397	Cum. Mcf
O&G: 469	Tbg pres		232	215	188	159	146	121	115	101	91	78	72	52		Tbg pres
	Csg pres		245	224	202	170	146	129	120	109	98	90	78	78		Csg pres
	Therms		114,783	161,630	167,878	209,281	175,360	147,171	124,195	116,010	104,161	84,519	66,782	55,401	1,527,171	Therms
	Cum. Therms		4,606,651	4,768,281	4,936,159	5,145,440	5,320,800	5,467,971	5,592,166	5,708,176	5,812,337	5,896,856	5,963,638	6,019,039	6,019,039	Cum. Therms
	Btu/cf		936	936	934	934	934	934	934	934	936	936	936	936	936	Btu/cf
	Days Prod		31	28	21	30	31	30	31	31	30	31	30	31	355	Days Prod
Nahama and Weagant	Mcf		SHUT IN	SHUT IN	SHUT IN	SHUT IN	SHUT IN	SHUT IN	SHUT IN	SHUT IN	SHUT IN	SHUT IN	SHUT IN	SHUT IN		Mcf
Columbia County 31-34	Cum. Mcf															Cum. Mcf
O&G: 386	Tbg pres															Tbg pres
	Csg pres															Csg pres
	Therms															Therms
	Cum. Therms															Cum. Therms
	Btu/cf															Btu/cf
	Days Prod															Days Prod
Nahama and Weagant	Mcf		SHUT IN	SHUT IN	SHUT IN	SHUT IN	SHUT IN	SHUT IN	SHUT IN	SHUT IN	SHUT IN	SHUT IN	SHUT IN	SHUT IN		Mcf
Columbia County 32-32	Cum. Mcf															Cum. Mcf
O&G: 339	Tbg pres															Tbg pres
	Csg pres															Csg pres
	Therms															Therms
	Cum. Therms															Cum. Therms
	Btu/cf															Btu/cf
	Days Prod															Days Prod

		Production												Production		
		1994	Jan	Feb	Mar	Apr	May	Jun	Jul	Aug	Sept	Oct	Nov	Dec	Year Totals	1994
Nahama and Weagant	Mcf								12,574	20,303	6,006	23,475	16,095	31,893	110,346	Mcf
CC 42-8-54	Cum. Mcf								12,574	32,877	38,883	62,358	78,453	110,346	110,346	Cum. Mcf
O&G: 376	Tbg pres															Tbg pres
	Csg pres								665	645	715	588	691	515		Csg pres
	Therms								86,887	140,295	41,501	162,210	111,213	220,384	762,490	Therms
	Cum. Therms								86,887	227,182	268,683	430,893	542,106	762,490	7,311,308	Cum. Therms
	Btu/cf								691	691	691	691	691	691	691	Btu/cf
	Days Prod								20	29	8	21	17	29	124	Days Prod
Nahama and Weagant	Mcf	47,594	40,196	29,645	41,664	41,858	37,286	38,197	35,968	32,977	29,443	28,071	28,197	431,096	Mcf	
Columbia County 43-33	Cum. Mcf	709,977	750,173	779,818	821,482	863,340	900,626	938,823	974,791	1,007,768	1,037,211	1,065,282	1,093,479	1,093,479	Cum. Mcf	
O&G: 470	Tbg pres	180	189	181	170	160	156	155	150	140	140	138	140		Tbg pres	
	Csg pres	223	226	220	208	199	190	183	179	173	170	165	165		Csg pres	
	Therms	470,224	397,133	292,892	411,640	413,557	368,386	377,385	355,361	325,815	290,900	277,345	278,582	4,259,220	Therms	
	Cum. Therms	7,019,042	7,416,175	7,709,067	8,120,707	8,534,264	8,902,650	9,280,035	9,635,396	9,961,211	10,252,111	10,529,456	10,808,038	10,808,038	Cum. Therms	
	Btu/cf	988	988	988	988	988	988	988	988	988	988	988	988	988	988	Btu/cf
	Days Prod	31	28	21	30	31	30	31	31	30	29	30	31	353	Days Prod	
Nahama and Weagant	Mcf	3,107	4,184	5,267	6,021	5,309	3,638	3,481	3,851	4,294	3,381	4,520	5,421	52,474	Mcf	
Columbia County 44-8	Cum. Mcf	89,001	93,185	98,452	104,473	109,782	113,420	116,901	120,752	125,046	128,427	132,947	138,368	138,368	Cum. Mcf	
O&G: 459	Tbg pres	250	235	246	230	215	220	220	225	220	205	225	215		Tbg pres	
	Csg pres	256	250	248	240	243	242	245	239	231	235	228	230		Csg pres	
	Therms	27,963	37,658	47,401	54,192	47,779	32,746	31,331	34,658	38,644	30,432	40,677	48,787	472,268	Therms	
	Cum. Therms	800,637	838,295	885,696	939,888	987,667	1,020,413	1,051,744	1,086,402	1,125,046	1,155,478	1,196,155	1,244,942	1,244,942	Cum. Therms	
	Btu/cf	900	900	900	900	900	900	900	900	900	900	900	900	900	900	Btu/cf
	Days Prod	31	28	22	30	31	30	31	30	29	21	23	29	335	Days Prod	
Nahama and Weagant	Mcf	8,154	6,752	226	SHUT IN	SHUT IN	SHUT IN	SHUT IN	SHUT IN	1,260	1,641	1,344	1,405	20,782	Mcf	
Columbia County 44-27	Cum. Mcf	692,167	698,919	699,145						1,260	2,901	4,245	5,650	704,795	Cum. Mcf	
O&G: 406	Tbg pres	55	63	25											Tbg pres	
	Csg pres	112	119	69						232	245	238	240		Csg pres	
	Therms	75,342	62,389	2,045						11,641	15,161	12,417	12,982	191,977	Therms	
	Cum. Therms	6,257,893	6,320,282	6,322,327						6,333,968	15,161	12,417	12,982	6,374,528	Cum. Therms	
	Btu/cf	924	924	907						924	924	924	924	924	Btu/cf	
	Days Prod	31	28	1						17	28	25	31	161	Days Prod	
Nahama and Weagant	Mcf	31,183	27,115	21,678	30,419	32,155	32,725	32,661	31,205	30,895	27,200	25,829	24,725	347,790	Mcf	
LF 12A-33	Cum. Mcf	575,729	602,844	624,522	654,941	687,096	719,821	752,482	783,687	814,582	841,782	867,611	892,336	892,336	Cum. Mcf	
O&G: 474	Tbg pres	365	374	370	330	320	299	287	255	250	249	287	279		Tbg pres	
	Csg pres	231	240	248	240	238	238	243	244	243	240	242	247		Csg pres	
	Therms	312,143	271,425	216,562	303,878	321,236	326,920	326,284	311,736	308,642	271,721	258,038	247,007	3,475,592	Therms	
	Cum. Therms	3,686,523	3,957,948	4,174,510	4,478,388	4,799,624	5,126,544	5,452,828	5,764,564	6,073,206	6,344,927	6,602,965	6,849,972	6,849,972	Cum. Therms	
	Btu/cf	1,001	1,001	999	999	999	999	999	999	999	999	999	999	999	Btu/cf	
	Days Prod	31	28	22	30	31	30	31	31	30	29	30	31	354	Days Prod	

		Production												Production		
		1994	Jan	Feb	Mar	Apr	May	Jun	Jul	Aug	Sept	Oct	Nov	Dec	Year Totals	1994
Nahama and Weagant	Mcf		50,753	51,492	28,299	52,144	51,077	45,790	44,660	39,750	38,898	25,089	26,358	33,537	487,847	Mcf
Longview Fibre	Cum. Mcf		430,757	482,249	510,548	562,692	613,769	659,559	704,219	743,969	782,867	807,956	834,314	867,851	867,851	Cum. Mcf
12B-35-65	Tbg pres		421	415	400	382	367	350	340	332	320	315	315	305		Tbg pres
	Csg pres		448	439	428	408	395	378	363	352	390	333	330	320		Csg pres
O&G: 476	Therms		473,016	479,902	347,177	472,682	463,016	415,082	404,845	360,331	355,531	229,314	240,915	306,524	4,548,335	Therms
	Cum. Therms		4,007,092	4,486,994	4,834,171	5,306,853	5,769,869	6,184,951	6,589,796	6,950,127	7,305,658	7,534,972	7,775,887	8,082,411	8,082,411	Cum. Therms
	Btu/cf		932	932	907	907	907	907	907	907	914	914	914	914	914	Btu/cf
	Days Prod		31	28	22	30	31	30	31	31	30	23	26	31	344	Days Prod
Nahama and Weagant	Mcf		25,107	14,271	9,753	8,302	6,169	3,293	3,658	3,397	2,752	2,185	2,852	3,265	85,004	Mcf
Longview Fibre 31-36	Cum. Mcf		62,164	76,435	86,188	94,490	100,659	103,952	107,610	111,007	113,759	115,944	118,796	122,061	122,061	Cum. Mcf
O&G: 478	Tbg pres		192	177	160	129	105	108	108	105	102	100	90	118		Tbg pres
	Csg pres		200	179	170	155	149	150	158	155	158	158	185	175		Csg pres
	Therms		227,718	129,442	88,544	75,537	56,011	29,902	33,206	30,839	24,978	19,843	25,892	29,641	771,553	Therms
	Cum. Therms		563,823	693,265	781,809	857,346	913,357	943,259	976,465	1,007,304	1,032,282	1,052,125	1,078,017	1,107,658	1,107,658	Cum. Therms
	Btu/cf		907	907	908	908	908	908	908	908	908	908	908	908	908	Btu/cf
	Days Prod		31	26	21	30	31	30	31	30	26	22	22	30	330	Days Prod
Nahama and Weagant	Mcf		3,405	2,825	2,163	3,716	3,388	3,213	3,280	3,030	2,915	2,110	2,028	2,405	34,478	Mcf
Longview Fibre 32-20	Cum. Mcf		341,303	344,128	346,291	350,007	353,395	356,608	359,888	362,918	365,833	367,943	369,971	372,376	372,376	Cum. Mcf
O&G: 412	Tbg pres															Tbg pres
	Csg pres		256	251	255	245	245	240	250	255	240	235	243	240		Csg pres
	Therms		33,812	28,053	21,481	36,903	33,647	31,909	32,573	30,095	28,946	20,953	20,139	23,886	342,397	Therms
	Cum. Therms		3,372,046	3,400,099	3,421,580	3,458,483	3,492,130	3,524,039	3,556,612	3,586,707	3,615,653	3,636,606	3,656,745	3,680,631	3,680,631	Cum. Therms
	Btu/cf		993	993	993	993	993	993	993	993	993	993	993	993	993	Btu/cf
	Days Prod		31	28	22	30	31	30	31	31	30	25	26	31	346	Days Prod
Nahama and Weagant	Mcf		55,881	52,088	37,245	45,509	39,238	28,790	23,216	14,748	11,348	7,248	8,935	7,798	332,044	Mcf
Longview Fibre 43-32	Cum. Mcf		195,590	247,678	284,923	330,432	369,670	398,460	421,676	436,424	447,772	455,020	463,955	471,753	471,753	Cum. Mcf
O&G: 477	Tbg pres		347	328	308	280	262	258	268	268	280	276	275	272		Tbg pres
	Csg pres		360	332	318	290	272	268	288	298	302	303	305	302		Csg pres
	Therms		546,514	509,416	361,946	442,254	381,314	279,783	225,614	143,324	110,286	70,434	86,831	75,780	3,233,496	Therms
	Cum. Therms		1,912,859	2,422,275	2,784,221	3,226,475	3,607,789	3,887,572	4,113,186	4,256,510	4,366,796	4,437,230	4,524,061	4,599,841	4,599,841	Cum. Therms
	Btu/cf		978	978	972	972	972	972	972	972	972	972	972	972	972	Btu/cf
	Days Prod		31	28	22	30	31	30	31	30	30	24	26	31	344	Days Prod

TOTAL MCF FOR THIS YEAR 4,369,580
TOTAL CUM. MCF TO DATE, MIST GAS FIELD 78,577,255

**Mist Gas Field
Production Figures
1995**

		Production												Production		
		1995	Jan	Feb	Mar	Apr	May	Jun	Jul	Aug	Sep	Oct	Nov	Dec	Year Totals	1995
Nahama and Weagant	Mcf		25,617	21,486	26,363	24,937	25,343	24,999	24,874	25,314	24,556	24,670	22,912	24,546	295,617	Mcf
CER 11-16-64	Cum. Mcf		828,020	849,506	875,869	900,806	926,149	951,148	976,022	1,001,336	1,025,892	1,050,562	1,073,474	1,098,020	1,098,020	Cum. Mcf
O&G: 449	Tbg pres		215	218	208	208	206	205	200	200	200	198	199	184		Tbg pres
	Csg pres		225	223	220	218	215	212	212	206	205	200	200	196		Csg pres
	Therms		226,969	190,369	233,571	221,935	225,557	222,490	221,380	225,293	218,553	219,558	203,917	218,460	2,628,052	Therms
	Cum. Therms		7,321,214	7,511,583	7,745,154	7,967,089	8,192,646	8,415,136	8,636,516	8,861,809	9,080,362	9,299,920	9,503,837	9,722,297	9,722,297	Cum. Therms
	Btu/cf		886	886	886	890	890	890	890	890	890	890	890	890		Btu/cf
	Days Prod		31	28	31	30	31	30	31	31	30	31	30	31	365	Days Prod
Nahama and Weagant	Mcf		44,865	38,300	46,974	44,879	45,662	44,767	44,976	44,786	42,939	42,027	41,337	43,047	524,559	Mcf
CER 41-16	Cum. Mcf		1,638,289	1,676,589	1,723,563	1,768,442	1,814,104	1,858,871	1,903,847	1,948,633	1,991,572	2,033,599	2,074,936	2,117,983	2,117,983	Cum. Mcf
O&G: 423	Tbg pres		-----	-----	-----	-----	-----	-----	-----	-----	-----	-----	-----	-----		Tbg pres
	Csg pres		235	230	225	225	224	224	221	219	218	210	212	204		Csg pres
	Therms		394,809	337,040	413,369	397,626	404,560	396,631	398,481	396,802	380,441	381,221	366,247	381,390	4,648,617	Therms
	Cum. Therms		14,385,601	14,722,641	15,136,010	15,533,636	15,938,196	16,334,827	16,733,308	17,130,110	17,510,551	17,891,772	18,258,019	18,639,409	18,639,409	Cum. Therms
	Btu/cf		880	880	880	886	886	886	886	886	886	886	886	886		Btu/cf
	Days Prod		31	28	31	30	31	30	31	31	30	31	30	31	365	Days Prod
Nahama and Weagant	Mcf		58,862	44,640	24,619	474	SHUT IN	1,708	10,376	2,632	1,102	156	171	0	144,740	Mcf
CFI 23-15	Cum. Mcf		353,753	398,393	423,012	423,486	423,486	425,194	435,570	438,202	439,304	439,460	439,631	439,631	439,631	Cum. Mcf
O&G: 324	Tbg pres		470	375	313	448		472	441	235	230	230	229	219		Tbg pres
	Csg pres		480	410	393	448		478	445	429	430	430	430	444		Csg pres
	Therms		383,194	290,603	160,273	3,085		11,116	67,550	17,137	7,174	1,014	1,114	0	942,260	Therms
	Cum. Therms		9,103,237	9,393,840	9,554,113	9,557,198	9,557,198	9,568,314	9,635,864	9,653,001	9,660,175	9,661,189	9,662,303	9,662,303	9,962,303	Cum. Therms
	Btu/cf		651	651	651	651		651	651	651	651	651	651	651		Btu/cf
	Days Prod		28	26	23	2		5	31	31	24	4	5	0	179	Days Prod
Nahama and Weagant	Mcf		52,123	33,526	26,547	7,375	SHUT IN	517	3,146	3,159	3,063	3,811	4,160	4,261	141,688	Mcf
CFI 31-16	Cum. Mcf		401,138	434,664	461,211	468,586	468,586	468,586	471,732	474,881	477,940	481,751	485,911	490,172	490,172	Cum. Mcf
O&G: 307	Tbg pres		472	430	380	640		660	665	662	685	695	528	580		Tbg pres
	Csg pres		611	580	575	640		669	672	685	697	695	695	698		Csg pres
	Therms		279,900	180,034	142,556	39,604		2,777	16,897	16,962	16,444	20,468	22,338	22,879	760,859	Therms
	Cum. Therms		11,618,985	11,799,019	11,941,575	11,981,179	11,981,179	11,983,956	12,000,853	12,017,815	12,034,259	12,054,727	12,077,065	12,099,944	12,099,944	Cum. Therms
	Btu/cf		537	537	537	537		537	537	537	537	537	537	537		Btu/cf
	Days Prod		28	26	26	8		5	31	31	30	31	30	31	277	Days Prod
Nahama and Weagant	Mcf		15,247	11,880	9,564	7,455	9,696	10,095	8,750	8,713	8,776	9,378	9,439	9,024	118,017	Mcf
CFW 12-15	Cum. Mcf		1,038,612	1,050,492	1,060,056	1,067,511	1,077,207	1,087,302	1,096,052	1,104,765	1,113,541	1,122,919	1,132,358	1,141,382	1,141,382	Cum. Mcf
O&G: 408	Tbg pres		-----	-----	-----	-----	-----	-----	-----	-----	-----	-----	-----	-----		Tbg pres
	Csg pres		210	200	188	192	190	188	170	186	182	180	180	178		Csg pres
	Therms		133,570	104,064	83,779	65,603	85,323	88,835	76,998	76,673	77,226	82,528	83,065	79,412	1,037,076	Therms
	Cum. Therms		9,097,865	9,201,929	9,285,708	9,351,311	9,436,634	9,525,469	9,602,467	9,679,140	9,756,366	9,838,894	9,921,959	10,001,371	10,001,371	Cum. Therms
	Btu/cf		876	876	876	880	880	880	880	880	880	880	880	880		Btu/cf
	Days Prod		31	28	31	30	31	30	31	31	30	31	30	31	365	Days Prod

		Production												Production	
1995		Jan	Feb	Mar	Apr	May	Jun	Jul	Aug	Sept	Oct	Nov	Dec	Year Totals	1995
Oregon Natural Gas Dev	Mcf	11,794	10,228	11,081	10,469	8,914	8,855	9,097	8,470	7,405	7,546	7,862	7,804	109,525	Mcf
Columbia County 13-34	Cum. Mcf	3,924,616	3,934,844	3,945,925	3,956,394	3,965,308	3,974,163	3,983,260	3,991,730	3,999,135	4,006,681	4,014,543	4,022,347	4,022,347	Cum. Mcf
O&G: 225	Tbg pres	125	140	120	128	100	-----	105	96	108	105	108	98		Tbg pres
	Csg pres	150	145	145	138	150	148	140	111	130	110	126	106		Csg pres
	Therms	116,635	101,161	109,589	103,328	87,978	87,397	89,785	83,597	73,089	74,479	77,596	77,028	1,081,662	Therms
	Cum. Therms	37,707,025	37,808,186	37,917,775	38,021,103	38,109,081	38,196,478	38,286,263	38,369,860	38,442,949	38,517,428	38,595,024	38,672,052	38,672,052	Cum. Therms
	Btu/cf	989	989	989	987	987	987	987	987	987	987	987	987		Btu/cf
	Days Prod	31	28	31	30	31	30	31	31	30	31	30	31	365	Days Prod
Oregon Natural Gas Dev	Mcf	SHUT IN	SHUT IN	SHUT IN	SHUT IN	SHUT IN	SHUT IN	SHUT IN	SHUT IN	SHUT IN	SHUT IN	SHUT IN	SHUT IN	0	Mcf
Columbia County 14-23	Cum. Mcf	4,739,479												4,739,479	Cum. Mcf
O&G: 318	Tbg pres														Tbg pres
	Csg pres														Csg pres
	Therms													0	Therms
	Cum. Therms	44,777,446												44,777,446	Cum. Therms
	Btu/cf														Btu/cf
	Days Prod													0	Days Prod
Oregon Natural Gas Dev	Mcf	2,550	1,905	2,307	2,105	1,762	1,587	1,349	1,291	1,259	1,194	996	863	19,168	Mcf
Columbia County 21-35	Cum. Mcf	522,112	524,017	526,324	528,429	530,191	531,778	533,127	534,418	535,677	536,871	537,867	538,730	538,730	Cum. Mcf
O&G: 393	Tbg pres	240	240	233	228	-----	232	230	225	225	230	235	225		Tbg pres
	Csg pres	250	245	238	232	228	225	230	230	225	230	235	225		Csg pres
	Therms	22,979	17,165	20,787	19,032	15,928	14,347	12,195	11,675	11,384	10,793	8,996	7,804	173,085	Therms
	Cum. Therms	4,662,738	4,679,903	4,700,690	4,719,722	4,735,650	4,749,997	4,762,192	4,773,867	4,785,251	4,796,044	4,805,040	4,812,844	4,812,844	Cum. Therms
	Btu/cf	901	901	901	904	904	904	904	904	904	904	904	904		Btu/cf
	Days Prod	31	28	31	30	28	30	31	31	30	31	30	31	362	Days Prod
Nahama and Weagant	Mcf	SHUT IN	SHUT IN	SHUT IN	SHUT IN	SHUT IN	SHUT IN	SHUT IN	SHUT IN	SHUT IN	SHUT IN	SHUT IN	SHUT IN	0	Mcf
Columbia Co. 22B-19	Cum. Mcf	236,390												236,390	Cum. Mcf
O&G: 481	Tbg pres														Tbg pres
	Csg pres														Csg pres
	Therms													0	Therms
	Cum. Therms	2,357,979												2,357,979	Cum. Therms
	Btu/cf														Btu/cf
	Days Prod													0	Days Prod
Oregon Natural Gas Dev	Mcf	SHUT IN	SHUT IN	SHUT IN	SHUT IN	SHUT IN	SHUT IN	SHUT IN	SHUT IN	SHUT IN	SHUT IN	SHUT IN	SHUT IN	0	Mcf
Columbia Co. 23-22	Cum. Mcf	5,438,879												5,438,879	Cum. Mcf
O&G: 237	Tbg pres														Tbg pres
	Csg pres														Csg pres
	Therms													0	Therms
	Cum. Therms	50,194,374												50,194,374	Cum. Therms
	Btu/cf														Btu/cf
	Days Prod													0	Days Prod

		Production												Production		
		1995	Jan	Feb	Mar	Apr	May	Jun	Jul	Aug	Sept	Oct	Nov	Dec	Year Totals	1995
Nahama and Weagant	Mcf		18,901	17,954	19,834	17,269	18,248	16,710	17,616	17,154	15,697	16,431	15,429	14,943	206,186	Mcf
Columbia County 24-9	Cum. Mcf		633,639	651,593	671,427	688,696	706,944	723,654	741,270	758,424	774,121	790,552	805,981	820,924	820,924	Cum. Mcf
O&G: 407	Tbg pres															Tbg pres
	Csg pres		215	204	188	195	195		175	178	180	178	170	168		Csg pres
	Therms		166,705	158,347	174,931	153,350	162,040	148,387	156,431	152,327	139,392	145,904	137,010	132,690	1,827,514	Therms
	Cum. Therms		5,563,522	5,721,869	5,896,800	6,050,150	6,212,190	6,360,577	6,517,008	6,669,335	6,808,727	6,954,631	7,091,641	7,224,331	7,224,331	Cum. Therms
	Btu/cf		882	882	882	888	888	888	888	888	888	888	888	888		Btu/cf
	Days Prod		31	28	31	30	31	30	31	31	30	31	30	31	365	Days Prod
Nahama and Weagant	Mcf		4,702	5,285	6,035	4,852	4,117	3,934	4,048	3,454	3,057	2,803	2,260	2,257	46,804	Mcf
Columbia County 31-15	Cum. Mcf		647,099	652,384	658,419	663,271	667,388	671,322	675,370	678,824	681,881	684,684	686,944	689,201	689,201	Cum. Mcf
O&G: 469	Tbg pres		35	38	38	35	30		20	17	15	10	12	8		Tbg pres
	Csg pres		62	55	49	45	42		25	25	18	15	15	10		Csg pres
	Therms		44,008	49,468	36,489	45,313	41,174	36,748	37,807	32,258	28,550	26,176	24,439	21,083	423,513	Therms
	Cum. Therms		6,063,047	6,112,515	6,149,004	6,194,317	6,235,491	6,272,239	6,310,046	6,342,304	6,370,854	6,397,030	6,421,469	6,442,552	6,442,552	Cum. Therms
	Btu/cf		936	936	936	934	934	934	934	934	934	934	934	934		Btu/cf
	Days Prod		31	28	31	30	31	30	31	31	30	31	30	31	365	Days Prod
Nahama and Weagant	Mcf		33,012	27,933	23,371	8,717	0	2,430	15,482	14,723	13,299	14,527	19,375	21,140	194,009	Mcf
CC 42-8-54	Cum. Mcf		143,258	171,191	194,562	203,279	203,279	205,709	221,191	235,914	249,213	263,740	283,115	304,255	304,255	Cum. Mcf
O&G: 376	Tbg pres															Tbg pres
	Csg pres		462	504	482	680		661	630	610	580	566	488	470		Csg pres
	Therms		228,111	193,014	161,493	60,234		16,794	106,984	101,737	91,893	100,378	133,877	146,072	1,340,587	Therms
	Cum. Therms		7,539,419	7,732,433	7,893,926	7,954,160	7,954,160	7,970,954	8,077,938	8,179,675	8,271,568	8,371,946	8,505,823	8,651,895	8,651,895	Cum. Therms
	Btu/cf		691	691	691	691		691	691	691	691	691	691	691		Btu/cf
	Days Prod		28	26	26	9		5	31	31	30	31	30	31	278	Days Prod
Oregon Natural Gas De	Mcf		27,494	20,917	24,773	22,258	21,730	20,450	20,961	20,013	19,047	18,618	17,124	17,033	250,418	Mcf
Columbia County 43-33	Cum. Mcf		1,120,973	1,141,890	1,166,663	1,188,921	1,210,651	1,231,101	1,252,062	1,272,075	1,291,122	1,309,740	1,326,864	1,343,897	1,343,897	Cum. Mcf
O&G: 470	Tbg pres		132	125	122	120	120	119	120	110	109	111	110	98		Tbg pres
	Csg pres		155	152	145	142	138	135	130	130	127	120	118	111		Csg pres
	Therms		271,638	206,658	244,758	219,907	214,695	202,045	207,100	197,732	188,189	183,946	169,186	168,284	2,474,138	Therms
	Cum. Therms		11,079,676	11,286,334	11,531,092	11,750,999	11,965,694	12,167,739	12,374,839	12,572,571	12,760,760	12,944,706	13,113,892	13,282,176	13,282,176	Cum. Therms
	Btu/cf		988	988	988	988	988	988	988	988	988	988	988	988		Btu/cf
	Days Prod		31	27	31	30	31	30	31	31	30	31	30	31	364	Days Prod
Nahama and Weagant	Mcf		4,058	3,875	3,540	2,745	2,794	2,757	2,668	2,555	2,347	2,764	2,658	2,347	35,108	Mcf
Columbia County 44-8	Cum. Mcf		142,426	146,301	149,841	152,586	155,380	158,137	160,805	163,360	165,707	168,471	171,129	173,476	173,476	Cum. Mcf
O&G: 459	Tbg pres		200	210	185	195	193	192	190	190	180	180	169	191		Tbg pres
	Csg pres		230	222	220	220	215	212	210	205	203	200	200	191		Csg pres
	Therms		36,518	34,877	31,860	24,655	25,087	24,759	23,956	22,942	21,075	24,663	23,867	21,079	315,338	Therms
	Cum. Therms		1,281,460	1,316,337	1,348,197	1,372,852	1,397,939	1,422,698	1,446,654	1,469,596	1,490,671	1,515,334	1,539,201	1,560,280	1,560,280	Cum. Therms
	Btu/cf		900	900	900	898	898	898	898	898	898	898	898	898		Btu/cf
	Days Prod		31	28	31	30	31	30	31	31	30	31	30	31	365	Days Prod

**Mist Gas Field
Production Figures
1996**

Production														Production	
1996		Jan	Feb	Mar	Apr	May	Jun	Jul	Aug	Sep	Oct	Nov	Dec	Year Totals	1996
Enerfin Resources	Mcf	24,462	11,599	17,096	26,048	26,211	24,789	26,002	25,469	22,546	24,629	22,367	20,221	271,439	Year Mcf
CER 11-16-64	Cum. Mcf	1,122,482	1,134,081	1,151,177	1,177,225	1,203,436	1,228,225	1,254,227	1,279,696	1,302,242	1,326,871	1,349,238	1,369,459	1,369,459	Cum. Mcf
O&G: 449	Tbg pres	190	195	175	165	160	160	157	156	156	150	148	148		Tbg pres
	Csg pres	195	200	195	176	172	170	168	167	165	161	159	158		Csg pres
	Therms	217,713	103,232	152,154	231,822	233,278	220,622	231,420	226,675	201,220	220,436	200,185	180,976	2,419,733	Year Therms
	Cum. Therms	9,940,010	10,043,242	10,195,396	10,427,218	10,660,496	10,881,118	11,112,538	11,339,213	11,540,433	11,760,869	11,961,054	12,142,030	12,142,030	Cum. Therms
	Btu/cf	890	890	890	890	890	890	890	890	893	895	895	895		Btu/cf
	Days Prod	31	17	27	30	31	30	31	31	30	31	30	31	350	Days Prod
Enerfin Resources	Mcf	40,475	18,606	28,420	36,916	41,817	38,695	36,599	38,644	35,893	38,007	34,386	24,343	412,801	Year Mcf
CER 41-16-64	Cum. Mcf	2,158,458	2,177,064	2,205,484	2,242,400	2,284,217	2,322,912	2,359,511	2,398,155	2,434,048	2,472,055	2,506,441	2,530,784	2,530,784	Cum. Mcf
O&G: 423	Tbg pres	-----	-----	-----	-----	-----	-----	-----	-----	-----	-----	-----	-----		Tbg pres
	Csg pres	195	195	198	186	184	182	182	181	180	177	172	173		Csg pres
	Therms	358,605	164,853	251,798	327,072	370,495	342,836	324,271	342,380	318,859	338,643	306,376	216,901	3,663,089	Year Therms
	Cum. Therms	18,998,014	19,162,867	19,414,665	19,741,737	20,112,232	20,455,068	20,779,339	21,121,719	21,440,578	21,779,221	22,085,597	22,302,498	22,302,498	Cum. Therms
	Btu/cf	886	886	886	886	886	886	886	886	888	891	891	891		Btu/cf
	Days Prod	31	17	27	30	31	30	31	31	30	31	30	28	347	Days Prod
Enerfin Resources	Mcf	22	5	23	5	0	0	34	0	0	0	0	1	90	Year Mcf
CFI 23-15	Cum. Mcf	439,653	439,658	439,681	439,686	439,686	439,686	439,720	439,720	439,720	439,720	439,720	439,721	439,721	Cum. Mcf
O&G: 324	Tbg pres	215	215	220	210	215	0	200					190		Tbg pres
	Csg pres	325	0	460	210	215	220	200					480		Csg pres
	Therms	141	31	122	28	0	0	180	0	0	0	0	6	508	Year Therms
	Cum. Therms	9,962,444	9,962,475	9,962,597	9,962,625	9,962,625	9,962,625	9,962,805	9,962,805	9,962,805	9,962,805	9,962,805	9,962,811	9,962,811	Cum. Therms
	Btu/cf	651	651	651	537	537	537	537	537	537	537	537	537		Btu/cf
	Days Prod	1	1	3	2	0	0	1	0	0	0	0	1	9	Days Prod
Enerfin Resources	Mcf	4,002	3,517	3,529	3,234	3,020	2,953	2,891	3,842	13,193	17,264	9,920	10,169	77,534	Year Mcf
CFI 31-16-54	Cum. Mcf	494,705	498,222	501,751	504,985	508,005	510,958	513,849	517,691	530,884	548,148	558,068	568,237	568,237	Cum. Mcf
O&G: 307	Tbg pres	625	495	560	530	530	530	533	520	684	690	685	632		Tbg pres
	Csg pres	700	700	700	680	680	680	687	690	717	696	698	684		Csg pres
	Therms	21,484	18,885	18,948	17,365	16,215	15,854	15,526	20,627	71,348	93,574	53,765	55,116	418,707	Year Therms
	Cum. Therms	12,121,428	12,140,313	12,159,261	12,176,626	12,192,841	12,208,695	12,224,221	12,244,848	12,316,196	12,409,770	12,463,535	12,518,651	12,518,651	Cum. Therms
	Btu/cf	537	537	537	537	537	537	537	537	539	542	542	542		Btu/cf
	Days Prod	31	29	31	30	31	30	31	31	22	30	30	31	357	Days Prod
Enerfin Resources	Mcf	Shut in	Shut in	Shut in	Shut in	Shut in	Shut in	Shut in	Shut in	43	Shut in	35	0	78	Year Mcf
CFI 34-01-55	Cum. Mcf									84,988	84,988	85,023	85,023	85,023	Cum. Mcf
O&G: 398	Tbg pres														Tbg pres
	Csg pres									263	210	207			Csg pres
Previous ARCO product	Therms									319	0	262		581	Year Therms
	Cum. Therms									618,068	618,068	618,330	0	618,330	Cum. Therms
	Btu/cf									747	747	747	747		Btu/cf
	Days Prod									3	4	7	0	14	Days Prod

		Production												Production		
		1996	Jan	Feb	Mar	Apr	May	Jun	Jul	Aug	Sep	Oct	Nov	Dec	Year Totals	1996
Enerfin Resources	Mcf	8,833	5,309	7,099	8,090	8,084	7,583	7,895	7,938	6,841	6,803	5,948	5,090	85,513	Year Mcf	
CFW 12-15-64	Cum. Mcf	1,150,215	1,155,524	1,162,623	1,170,713	1,178,797	1,186,380	1,194,275	1,202,213	1,209,054	1,215,857	1,221,805	1,226,895	1,226,895	Cum. Mcf	
O&G: 408	Tbg pres	-----	-----	-----	-----	-----	-----	-----	-----	-----	-----	-----	-----	-----	Tbg pres	
	Csg pres	175	175	175	160	159	160	160	158	158	154	154	156		Csg pres	
	Therms	77,729	46,714	62,333	71,028	70,974	66,574	69,321	69,695	60,228	60,070	52,522	44,945	752,133	Year Therms	
	Cum. Therms	10,079,100	10,125,814	10,188,147	10,259,175	10,330,149	10,396,723	10,466,044	10,535,739	10,595,967	10,656,037	10,708,559	10,753,504	10,753,504	Cum. Therms	
	Btu/cf	880	880	878	878	878	878	878	878	880	883	883	883		Btu/cf	
	Days Prod	31	17	27	30	31	30	31	31	30	31	30	28	347	Days Prod	
Enerfin Resources	Mcf	14,215	10,120	20,637	29,569	23,846	20,823	22,014	22,567	23,059	20,181	20,581	23,199	250,811	Year Mcf	
Columbia Co. 24-9-64	Cum. Mcf	835,139	845,259	865,896	895,465	919,311	940,134	962,148	984,715	1,007,774	1,027,955	1,048,536	1,071,735	1,071,735	Cum. Mcf	
O&G: 407	Tbg pres	-----	-----	-----	-----	-----	-----	-----	-----	-----	-----	-----	-----	-----	Tbg pres	
	Csg pres	160	180	165	150	130	138	131	134	140	131	130	137		Csg pres	
	Therms	126,224	89,866	183,253	262,568	211,752	184,909	203,480	200,397	205,209	180,010	183,583	206,932	2,238,183	Year Therms	
	Cum. Therms	7,350,555	7,440,421	7,623,674	7,886,242	8,097,994	8,282,903	8,486,383	8,686,780	8,891,989	9,071,999	9,255,582	9,462,514	9,462,514	Cum. Therms	
	Btu/cf	888	888	888	888	888	888	888	888	890	892	892	892		Btu/cf	
	Days Prod	31	16	28	30	31	30	31	31	30	31	30	31	350	Days Prod	
Enerfin Resources	Mcf	1,934	1,599	1,914	1,641	1,468	1,296	1,870	1,278	1,298	894	787	780	16,759	Year Mcf	
Columbia Co. 31-15-65	Cum. Mcf	691,135	692,734	694,648	696,289	697,757	699,053	700,923	702,201	703,499	704,393	705,180	705,960	705,960	Cum. Mcf	
O&G: 469	Tbg pres	10	10	10	8	8	8	7	4	3	1	1	1		Tbg pres	
	Csg pres	15	15	15	12	10	20	19	9	7	4	4	3		Csg pres	
	Therms	18,061	14,939	17,879	15,331	13,708	12,104	17,462	11,937	12,151	8,394	7,394	7,330	156,690	Year Therms	
	Cum. Therms	6,460,613	6,475,552	6,493,431	6,508,762	6,522,470	6,534,574	6,552,036	6,563,973	6,576,124	6,584,518	6,591,912	6,599,242	6,599,242	Cum. Therms	
	Btu/cf	934	934	934	934	934	934	934	934	936	939	939	939		Btu/cf	
	Days Prod	31	20	30	30	31	18	30	28	30	31	30	31	340	Days Prod	
Enerfin Resources	Mcf	20,057	16,934	19,251	18,595	20,254	21,755	22,523	21,976	20,443	18,891	12,723	12,717	226,119	Year Mcf	
Columbia Co. 42-8-54	Cum. Mcf	324,312	341,246	360,497	379,497	399,751	421,506	444,029	466,005	486,448	505,339	518,062	530,779	530,779	Cum. Mcf	
O&G: 376	Tbg pres	-----	-----	-----	-----	-----	-----	-----	-----	-----	-----	-----	-----	-----	Tbg pres	
	Csg pres	465	452	460	420	440	448	446	444	461	475	504	470		Csg pres	
	Therms	138,594	117,011	142,839	137,974	150,283	161,422	167,116	163,064	152,163	141,302	95,167	95,125	1,662,060	Year Therms	
	Cum. Therms	8,790,490	8,907,501	9,050,340	9,188,314	9,338,597	9,500,019	9,667,135	9,830,199	9,982,362	10,123,664	10,218,831	10,313,956	10,313,956	Cum. Therms	
	Btu/cf	691	691	742	742	742	742	742	742	744	748	748	748		Btu/cf	
	Days Prod	31	27	31	30	31	30	31	31	30	30	30	31	363	Days Prod	
Enerfin Resources	Mcf	1,911	2,222	3,945	5,171	6,476	5,986	3,457	4,416	4,660	3,954	2,492	3,384	48,074	Year Mcf	
Columbia Co. 44-8-64	Cum. Mcf	175,387	177,609	181,554	186,725	193,201	199,187	202,644	207,060	211,720	215,674	218,166	221,550	221,550	Cum. Mcf	
O&G: 459	Tub pres	160	190	175	146	132	136	126	134	135	135	139	131		Tbg pres	
	Csg pres	215	190	155	148	155	140	157	156	145	147	149	136		Csg pres	
	Therms	17,161	19,950	35,347	46,333	58,030	53,636	30,977	39,565	41,794	35,504	22,378	30,386	431,061	Year Therms	
	Cum. Therms	1,577,441	1,597,391	1,632,738	1,679,071	1,737,101	1,790,737	1,821,714	1,861,279	1,903,073	1,938,577	1,960,955	1,991,341	1,991,341	Cum. Therms	
	Btu/cf	898	898	896	896	896	896	896	896	897	898	898	898		Btu/cf	
	Days Prod	31	17	26	30	31	30	31	31	30	31	30	31	349	Days Prod	

Production		Jan	Feb	Mar	Apr	May	Jun	Jul	Aug	Sep	Oct	Nov	Dec	Year Totals	Production
1996															1996
Enerfin Resources	Mcf	9,005	5,983	6,385	8,254	10,568	9,484	7,726	9,731	8,046	8,073	6,786	5,405	95,446	Year Mcf
Longview Fibre 12A-33-	Cum. Mcf	984,534	990,517	996,902	1,005,156	1,015,724	1,025,208	1,032,934	1,042,665	1,050,711	1,058,784	1,065,570	1,070,975	1,070,975	Cum. Mcf
O&G: 474	Tbg pres	225	230	175	135	95	100	115	155	168	171	180	213		Tbg pres
	Csg pres	225	240	275	640	105	100	130	215	236	221	237	273		Csg pres
	Therms	89,872	59,709	63,850	82,540	105,682	94,835	77,265	97,307	80,621	81,053	68,134	54,267	955,135	Year Therms
	Cum. Therms	7,770,518	7,830,227	7,894,077	7,976,617	8,082,299	8,177,134	8,254,399	8,351,706	8,432,327	8,513,380	8,581,514	8,635,781	8,635,781	Cum. Therms
	Btu/cf	998	998	1,000	1,000	1,000	1,000	1,000	1,000	1,002	1,004	1,004	1,004		Btu/cf
	Days Prod	31	26	26	28	31	30	31	31	30	31	30	30	355	Days Prod
Enerfin Resources	Mcf	Shut-in	Shut-in	2,271	4,323	3,808	1,949	1,328	1,340	1,247	1,173	1,201	980	19,620	Year Mcf
Longview Fibre 31-36	Cum. Mcf			252,616	256,939	260,747	262,696	264,024	265,364	266,611	267,784	268,985	269,965	269,965	Cum. Mcf
O&G: 478	Tub pres			300	285	245	215	215	217	216	213	215	223		Tub pres
	Csg Pres			310	295	250	240	240	240	239	233	237	239		Csg pres
	Therms			20,643	39,292	34,613	17,716	12,074	12,176	11,294	10,558	10,810	8,819	177,995	Year Therms
	Cum. Therms			1,158,803	1,198,095	1,232,708	1,250,424	1,262,498	1,274,674	1,285,968	1,296,526	1,307,336	1,316,155	1,316,155	Cum. Therm
	Btu/cf			0.19670	909	909	909	909	909	905	900	900	900		Btu/cf
	Days Prod			17	30	31	30	31	31	30	31	30	31	292	Days Prod
Enerfin Resources	Mcf	1,951	1,576	1,728	1,644	1,606	2,754	3,401	2,307	2,539	2,160	1,807	1,311	24,784	Year Mcf
Longview Fibre 32-20	Cum. Mcf	400,372	401,948	403,676	405,320	406,926	409,680	413,081	415,388	417,927	420,087	421,894	423,205	423,205	Cum. Mcf
O&G: 412	Tbg pres	-----	-----	-----	-----	-----	-----	-----	-----	-----	-----	-----	-----		Tbg pres
	Csg pres	230	230	220	215	215	210	216	213	217	211	208	209		Csg pres
	Therms	19,362	15,632	17,143	16,304	15,927	27,319	33,734	22,882	25,192	21,425	17,933	13,016	245,869	Year Therms
	Cum. Therms	3,958,414	3,974,046	3,991,189	4,007,493	4,023,420	4,050,739	4,084,473	4,107,355	4,132,547	4,153,972	4,171,905	4,184,921	4,184,921	Cum. Therms
	Btu/cf	992	992	992	992	992	992	992	992	992	992	992	993		Btu/cf
	Days Prod	31	26	29	30	31	30	31	31	30	31	28	23	351	Days Prod
Enerfin Resources	Mcf	3,342	1,469	986	1,430	1,129	1,174	1,215	500	487	858	162	306	13,058	Year Mcf
Longview Fibre 43-32	Cum. Mcf	550,567	552,036	553,082	554,512	555,641	556,815	558,030	558,530	559,017	559,875	560,037	560,343	560,343	Cum. Mcf
O&G: 477	Tbg pres	230	265	245	250	250	235	232	234	235	235	260	254		Tbg pres
	Csg pres	280	295	300	300	310	310	310	318	271	275	290	313		Csg pres
	Therms	32,446	14,263	9,561	13,868	10,947	11,389	11,788	4,850	4,763	8,384	1,581	2,992	126,832	Year Therms
	Cum. Therms	5,365,228	5,379,491	5,389,052	5,402,920	5,413,867	5,425,256	5,437,044	5,441,894	5,446,657	5,455,041	5,456,622	5,459,614	5,459,614	Cum. Therms
	Btu/cf	971	971	970	970	970	970	970	970	973	977	977	977		Btu/cf
	Days Prod	31	25	29	30	30	30	31	14	10	29	5	13	277	Days Prod
Northwest Natural Gas	Mcf	0	0	290	778	1,258	1,445	1,897	1,303	1,322	1,375	910	337	10,915	Year Mcf
Columbia Co. 13-34-75	Cum. Mcf	4,022,347	4,022,347	4,022,637	4,023,415	4,024,673	4,026,118	4,028,015	4,029,318	4,030,640	4,032,015	4,032,925	4,033,262	4,033,262	Cum. Mcf
O&G: 225	Tbg pres	150	151	140	147	136	144	140	140	138	132	130	147		Tbg pres
	Csg pres	152	151	146	149	142	146	147	147	141	139	140	147		Csg pres
	Therms	0	0	2,900	7,775	12,568	14,441	18,941	13,027	13,160	13,632	9,029	3,344	108,817	Year Therms
	Cum. Therms	38,672,052	38,672,052	38,674,952	38,682,727	38,695,295	38,709,736	38,728,677	38,741,704	38,754,864	38,768,496	38,777,525	38,780,869	38,780,869	Cum. Therms
	Btu/cf	987	987	999	999	999	999	999	999	996	992	992	992		Btu/cf
	Days Prod	0	0	6	24	31	30	29	31	30	31	30	28	270	Days Prod

		Production 1996												Production 1996	
		Jan	Feb	Mar	Apr	May	Jun	Jul	Aug	Sep	Oct	Nov	Dec	Year Totals	1996
Northwest Natural Gas	Mcf	Shut-in	Shut-in	668	Storage	Storage	Storage	Storage	Storage	Storage	Storage	Storage	Storage	668	Year Mcf
Columbia Co. 14-23	Cum. Mcf			4,740,147										4,740,147	Cum. Mcf
O&G: 318	Tub pres			-----											Tub pres
	Csg pres			-----											Csg pres
	Therms			6,501										6,501	Year Therms
	Cum. Therm			44,783,947										44,783,947	Cum. Therms
	Btu/cf			974											Btu/cf
	Days Prod			2										2	Days Prod
Northwest Natural Gas	Mcf	789	786	162	Shut-in	Shut-in	Shut-in	Shut-in	Shut-in	Shut-in	Shut in	Shut in	Shut in	1,737	Year Mcf
Columbia Co. 21-35	Cum. Mcf	539,519	540,305	540,467										540,467	Cum. Mcf
O&G: 393	Tbg pres	217	217	217											Tbg pres
	Csg pres	214	214	214											Csg pres
	Therms	7,131	7,104	1,466										15,701	Year Therms
	Cum. Therms	4,819,975	4,827,079	4,828,545										4,828,545	Cum. Therms
	Btu/cf	904	904	904											Btu/cf
	Days Prod	31	26	8										65	Days Prod
Northwest Natural Gas	Mcf	Shut-in	Shut-in	2,177	Storage	Storage	Storage	Storage	Storage	Storage	Storage	Storage	Storage	2,177	Year Mcf
Columbia Co. 23-22	Cum. Mcf			5,381,056										5,381,056	Cum. Mcf
O&G: 237	Tub pres			-----											Tub pres
	Csg pres			-----											Csg pres
	Therms			21,205										21,205	Year Therms
	Cum. Therms			52,123,612										52,123,612	Cum. Therm
	Btu/cf			974											Btu/cf
	Days Prod			3										3	Days Prod
Northwest Natural Gas	Mcf	15,339	10,380	11,676	2,595	4,286	5,254	5,304	4,977	4,763	4,484	4,241	3,152	76,451	Year Mcf
Columbia Co. 43-33-75	Cum. Mcf	1,359,236	1,369,616	1,381,292	1,383,887	1,388,173	1,393,427	1,398,731	1,403,708	1,408,471	1,412,955	1,417,196	1,420,348	1,420,348	Cum. Mcf
O&G: 470	Tbg pres	98	94	139	146	136	138	136	130	128	125	130	140		Tbg pres
	Csg pres	111	108	140	147	136	139	137	133	130	126	130	141		Csg pres
	Therms	152,140	102,558	115,355	25,642	42,342	51,907	52,401	49,170	47,180	44,524	42,115	31,302	756,636	Year Therms
	Cum. Therms	13,434,316	13,536,874	13,652,229	13,677,871	13,720,213	13,772,120	13,824,521	13,873,691	13,920,871	13,965,395	14,007,510	14,038,812	14,038,812	Cum. Therms
	Btu/cf	988	988	988	988	988	988	988	988	991	993	993	993		Btu/cf
	Days Prod	29	22	29	23	31	30	29	31	30	31	30	29	344	Days Prod
Northwest Natural Gas	Mcf	886	623	625	667	633	677	668	658	631	572	589	585	7,814	Year Mcf
Columbia County 44-27	Cum. Mcf	716,877	717,500	718,125	718,792	719,425	720,102	720,770	721,428	722,059	722,631	723,220	723,805	723,805	Cum. Mcf
O&G: 406	Tbg pres	-----	-----	-----	-----	-----	-----	-----	-----	-----	-----	-----	-----		Tbg pres
	Csg pres	209	212	220	205	200	205	205	200	200	200	200	200		Csg pres
	Therms	8,070	5,799	5,815	6,205	5,895	6,304	6,218	6,123	5,883	5,351	5,511	5,465	72,639	Year Therms
	Cum. Therms	6,486,593	6,492,392	6,498,207	6,504,412	6,510,307	6,516,611	6,522,829	6,528,952	6,534,835	6,540,186	6,545,697	6,551,162	6,551,162	Cum. Therms
	Btu/cf	931	931	931	931	931	931	931	931	933	935	935	935		Btu/cf
	Days Prod	31	26	30	30	31	30	31	31	30	31	30	31	362	Days Prod
Northwest Natural Gas	Mcf	11,360	9,172	10,507	9,769	7,975	7,994	8,084	8,215	7,593	6,952	7,201	5,850	100,672	Year Mcf
Longview Fibre 12B-35	Cum. Mcf	1,114,508	1,123,680	1,134,187	1,143,956	1,151,931	1,159,925	1,168,009	1,176,224	1,183,817	1,190,769	1,197,970	1,203,820	1,203,820	Cum. Mcf
O&G: 476	Tbg pres	236	240	237	238	227	234	232	221	221	220	220	219		Tbg pres
	Csg pres	245	243	241	239	231	236	235	225	224	223	222	220		Csg pres
	Therms	102,922	83,079	95,085	88,412	72,176	72,343	73,159	74,344	68,920	63,334	65,601	53,296	912,671	Year Therms
	Cum. Therms	10,323,687	10,406,766	10,501,851	10,590,263	10,662,439	10,734,782	10,807,941	10,882,285	10,951,205	11,014,539	11,080,140	11,133,436	11,133,436	Cum. Therms
	Btu/cf	906	906	905	905	905	905	905	905	908	911	911	911		Btu/cf
	Days Prod	31	27	29	30	31	30	31	31	30	30	30	31	361	Days Prod

TOTAL MCF FOR YEAR 1,742,560
TOTAL CUM. MCF TO DATE, MIST GAS FIELD 82,840,217

**Mist Gas Field
Production Figures
1997**

		Production													Production
1997		Jan	Feb	Mar	Apr	May	Jun	Jul	Aug	Sep	Oct	Nov	Dec	Year Totals	1997
Enerfin Resources	Mcf	21,509	21,372	19,072	20,869	18,585	20,994	21,046	22,124	18,839	20,651	20,842	22,357	248,260	Mcf
CER 11-16-64	Cum. Mcf	1,390,968	1,412,340	1,431,412	1,452,281	1,470,866	1,491,860	1,512,906	1,535,030	1,553,869	1,574,520	1,595,362	1,617,719	1,617,719	Cum. Mcf
O&G 449	Tbg. Pres.	149	144	146	144	145	140	138	133	139	132	127	121		Tbg. Pres.
	Csg. Pres.	157	154	155	152	152	149	147	143	146	140	137	132		Csg. Pres.
	Therms	192,502	191,279	170,223	185,735	165,408	186,848	187,311	196,906	167,673	183,796	185,497	198,977	2,212,155	Therms
	Cum. Therms	12,334,532	12,525,811	12,696,034	12,881,769	13,047,177	13,234,025	13,421,336	13,618,242	13,785,915	13,969,711	14,155,208	14,354,185	14,354,185	Cum. Therms
	Btu/cf	895	895	893	890	890	890	890	890	890	890	890	890		Btu/cf
	Days Prod.	31	28	31	30	31	30	31	31	30	31	30	31	365	Days Prod.
Enerfin Resources	Mcf	shut in	shut in	shut in	shut in	shut in	shut in	shut in	shut in	shut in	1,094	469	146	1,709	Mcf
CER 13-01-55	Cum. Mcf										50,256	50,725	50,871	50,871	Cum. Mcf
O&G 436	Tbg. Pres.														Tbg. Pres.
	Csg. Pres.										233	207	210		Csg. Pres.
	Therms										9,013	3,865	1,201	14,079	Therms
	Cum. Therms										379,423	383,288	384,489	384,489	Cum. Therms
	Btu/cf										824	824	824		Btu/cf
	Days Prod.										31	30	31	92	Days Prod.
Enerfin Resources	Mcf	32,092	33,011	34,932	34,343	35,692	33,514	33,358	34,981	27,593	31,097	31,902	31,629	394,144	Mcf
CER 41-16-64	Cum. Mcf	2,562,876	2,595,887	2,630,819	2,665,162	2,700,854	2,734,368	2,767,726	2,802,707	2,830,300	2,861,397	2,893,299	2,924,928	2,924,928	Cum. Mcf
O&G 423	Tbg. Pres.														Tbg. Pres.
	Csg. Pres.	171	168	165	164	162	160	159	156	157	152	150	148		Csg. Pres.
	Therms	285,935	294,127	310,482	304,279	316,226	296,937	295,557	309,935	244,472	275,521	282,646	280,237	3,496,354	Therms
	Cum. Therms	22,588,433	22,882,560	23,193,042	23,497,321	23,813,547	24,110,484	24,406,041	24,715,976	24,960,448	25,235,969	25,518,615	25,798,852	25,798,852	Cum. Therms
	Btu/cf	891	891	889	886	886	886	886	886	886	886	886	886		Btu/cf
	Days Prod.	29	28	31	30	31	30	31	31	29	31	30	31	362	Days Prod.
Enerfin Resources	Mcf	163	52	shut in	51	1	shut in	shut in	shut in	shut in	shut in	274	shut in	541	Mcf
CFI 23-15	Cum. Mcf	439,884	439,936		439,987	439,988						440,262		440,262	Cum. Mcf
O&G 324	Tbg. Pres.	200	200	200	200	181	190					150			Tbg. Pres.
	Csg. Pres.	485	483	480	353	408	229					513			Csg. Pres.
	Therms	877	275		275	8						1,462		2,897	Therms
	Cum. Therms	9,963,688	9,963,963		9,964,238	9,964,246						9,965,708		9,965,708	Cum. Therms
	Btu/cf	537	537		535	534						534			Btu/cf
	Days Prod.	30	25		9	5						4		73	Days Prod.
Enerfin Resources	Mcf	11,298	6,320	3,162	1,096	1,182	1,552	1,598	1,815	738	1,077	224	386	30,448	Mcf
CFI 31-16-54	Cum. Mcf	579,535	585,855	589,017	590,113	591,295	592,847	594,445	596,260	596,998	598,075	598,299	598,685	598,685	Cum. Mcf
O&G 307	Tbg. Pres.	535	385	341	284	304	413	437	442	320	245	190	184		Tbg. Pres.
	Csg. Pres.	642	541	588	644	670	659	656	603	645	618	713	703		Csg. Pres.
	Therms	61,236	34,254	17,136	5,913	6,309	8,290	8,534	9,693	3,940	5,753	1,196	2,063	164,317	Therms
	Cum. Therms	12,579,887	12,614,141	12,631,277	12,637,190	12,643,499	12,651,789	12,660,323	12,670,016	12,673,956	12,679,709	12,680,905	12,682,968	12,682,968	Cum. Therms
	Btu/cf	542	542	542	536	534	534	534	534	534	534	534	534		Btu/cf
	Days Prod.	31	28	31	24	31	30	31	31	18	21	6	7	289	Days Prod.

		Production												Production		
1997		Jan	Feb	Mar	Apr	May	Jun	Jul	Aug	Sep	Oct	Nov	Dec	Year Totals	1997	
Enerfin Resources	Mcf	shut in	shut in	shut in	shut in	shut in	shut in	shut in	shut in	shut in	abandoned	abandoned	abandoned	abandoned		Mcf
CFI 34-01-55	Cum. Mcf													85,023	Cum. Mcf	
O&G 398	Tbg. Pres.														Tbg. Pres.	
Previous ARCO producer	Csg. Pres.														Csg. Pres.	
	Therms														Therms	
	Cum. Therms													618,330	Cum. Therms	
	Btu/cf														Btu/cf	
	Days Prod.													0	Days Prod.	
Enerfin Resources	Mcf	6,549	6,222	5,884	5,933	5,443	5,130	5,615	5,233	5,359	6,551	5,755	5,694	69,368	Mcf	
CFW 12-15-64	Cum. Mcf	1,233,444	1,239,666	1,245,550	1,251,483	1,256,926	1,262,056	1,267,671	1,272,904	1,278,263	1,284,814	1,290,569	1,296,263	1,296,263	Cum. Mcf	
O&G 408	Tbg. Pres.														Tbg. Pres.	
	Csg. Pres.	155	147	147	145	141	142	141	137	146	137	130	130		Csg. Pres.	
	Therms	57,830	54,937	51,814	52,092	47,793	45,044	49,305	45,945	47,046	57,501	50,471	49,935	609,713	Therms	
	Cum. Therms	10,811,334	10,866,271	10,918,085	10,970,177	11,017,970	11,063,014	11,112,319	11,158,264	11,205,310	11,262,811	11,313,282	11,363,217	11,363,217	Cum. Therms	
	Btu/cf	883	883	881	878	878	878	878	878	878	878	877	877		Btu/cf	
	Days Prod.	30	28	31	30	31	30	31	31	29	31	30	31	363	Days Prod.	
Enerfin Resources	Mcf	15,875	13,234	16,447	14,081	14,518	12,462	13,887	11,957	12,790	12,803	11,508	15,980	165,542	Mcf	
Columbia County	Cum. Mcf	1,087,610	1,100,844	1,117,291	1,131,372	1,145,890	1,158,352	1,172,239	1,184,196	1,196,986	1,209,789	1,221,297	1,237,277	1,237,277	Cum. Mcf	
O&G 407	Tbg. Pres.														Tbg. Pres.	
	Csg. Pres.	137	128	140	135	142	128	127	118	128	119	111	102		Csg. Pres.	
	Therms	141,612	118,049	146,399	125,040	128,916	110,659	123,313	106,175	113,574	113,693	102,191	141,902	1,471,523	Therms	
	Cum. Therms	9,604,126	9,722,175	9,868,574	9,993,614	10,122,530	10,233,189	10,356,502	10,462,677	10,576,251	10,689,944	10,792,135	10,934,037	10,934,037	Cum. Therms	
	Btu/cf	892	892	890	888	888	888	888	888	888	888	888	888		Btu/cf	
	Days Prod.	31	28	31	30	31	30	31	31	30	31	30	31	365	Days Prod.	
Enerfin Resources	Mcf	805	800	753	673	717	688	609	327	13	409	260	77	6,131	Mcf	
Columbia County	Cum. Mcf	706,765	707,565	708,318	708,991	709,708	710,396	711,005	711,332	711,345	711,754	712,014	712,091	712,091	Cum. Mcf	
O&G 469	Tbg. Pres.	1	1	1	1	1	1	1	1	1	0	0	0		Tbg. Pres.	
	Csg. Pres.	3	3	3	3	3	3	2	2	13	0	0	0		Csg. Pres.	
	Therms	7,561	7,512	7,050	6,279	6,689	6,424	5,686	3,047	124	3,807	2,425	720	57,324	Therms	
	Cum. Therms	6,606,803	6,614,315	6,621,365	6,627,644	6,634,333	6,640,757	6,646,443	6,649,490	6,649,614	6,653,421	6,655,846	6,656,566	6,656,566	Cum. Therms	
	Btu/cf	939	939	936	933	933	933	933	933	933	932	931	931		Btu/cf	
	Days Prod.	28	28	31	30	31	30	31	19	5	31	30	23	317	Days Prod.	
Enerfin Resources	Mcf	shut in	shut in	shut in	shut in	shut in	shut in	shut in	shut in	shut in	510	0	64	574	Mcf	
Columbia County	Cum. Mcf										6,459	6,459	6,523	6,523	Cum. Mcf	
O&G 458	Tbg. Pres.										348		70		Tbg. Pres.	
	Csg. Pres.										532		605		Csg. Pres.	
	Therms										4,988	0	622	5,610	Therms	
	Cum. Therms										63,196	63,196	63,818	63,818	Cum. Therms	
	Btu/cf										978	978	978		Btu/cf	
	Days Prod.										19	0	2	21	Days Prod.	

Production														Production	
1997		Jan	Feb	Mar	Apr	May	Jun	Jul	Aug	Sep	Oct	Nov	Dec	Year Totals	1997
Enerfin Resources	Mcf	11,900	10,206	12,195	16,142	18,543	17,583	15,423	16,981	17,027	19,011	14,493	18,494	187,998	Mcf
Columbia County	Cum. Mcf	542,679	552,885	565,080	581,222	599,765	617,348	632,771	649,752	666,779	685,790	700,283	718,777	718,777	Cum. Mcf
42-8-54	Tbg. Pres.														Tbg. Pres.
O&G 376	Csg. Pres.	450	433	414	484	519	519	521	529	519	497	500	464		Csg. Pres.
	Therms	89,015	76,343	91,216	119,779	137,403	130,293	114,286	125,827	126,164	140,816	107,250	136,851	1,395,243	Therms
	Cum. Therms	10,402,971	10,479,314	10,570,530	10,690,309	10,827,712	10,958,005	11,072,291	11,198,118	11,324,282	11,465,098	11,572,348	11,709,199	11,709,199	Cum. Therms
	Btu/cf	748	748	748	742	741	741	741	741	741	741	740	740		Btu/cf
	Days Prod.	31	28	31	30	31	30	30	31	28	30	28	31	359	Days Prod.
Enerfin Resources	Mcf	2,399	2,880	2,592	2,771	2,379	2,240	2,807	2,850	230	1,852	2,280	1,700	26,980	Mcf
Columbia County	Cum. Mcf	223,949	226,829	229,421	232,192	234,571	236,811	239,618	242,468	242,698	244,550	246,830	248,530	248,530	Cum. Mcf
44-8-64	Tbg. Pres.	128	126	138	136	138	123	124	113	110	118	111	98		Tbg. Pres.
O&G 459	Csg. Pres.	133	131	129	128	126	121	119	110	133	113	102	103		Csg. Pres.
	Therms	21,541	25,864	23,235	24,778	21,271	20,030	25,093	25,480	2,060	16,552	20,362	15,186	241,452	Therms
	Cum. Therms	2,012,882	2,038,746	2,061,981	2,086,759	2,108,030	2,128,060	2,153,153	2,178,633	2,180,693	2,197,245	2,217,607	2,232,793	2,232,793	Cum. Therms
	Btu/cf	898	898	896	894	894	894	894	894	894	894	893	893		Btu/cf
	Days Prod.	31	28	31	29	31	29	31	31	3	24	30	31	329	Days Prod.
Enerfin Resources	Mcf	5,726	6,425	7,632	7,156	7,321	6,633	7,006	7,832	6,968	7,296	7,421	6,807	84,223	Mcf
Longview Fibre	Cum. Mcf	1,076,701	1,083,126	1,090,758	1,097,914	1,105,235	1,111,868	1,118,874	1,126,706	1,133,674	1,140,970	1,148,391	1,155,198	1,155,198	Cum. Mcf
12A-33-76	Tbg. Pres.	195	155	155	133	135	153	148	112	113	108	117	143		Tbg. Pres.
O&G 475	Csg. Pres.	266	240	240	205	216	221	221	190	197	208	186	210		Csg. Pres.
	Therms	57,490	64,504	76,519	71,636	73,269	66,386	70,123	78,402	69,738	73,013	74,205	68,074	843,359	Therms
	Cum. Therms	8,693,271	8,757,775	8,834,294	8,905,930	8,979,199	9,045,585	9,115,708	9,194,110	9,263,848	9,336,861	9,411,066	9,479,140	9,479,140	Cum. Therms
	Btu/cf	1,004	1,004	1,003	1,001	1,001	1,001	1,001	1,001	1,001	1,001	1,000	1,000		Btu/cf
	Days Prod.	31	28	31	30	31	30	31	31	30	31	30	31	365	Days Prod.
Enerfin Resources	Mcf	815	886	1,161	1,231	1,168	915	837	691	766	724	717	721	10,632	Mcf
Longview Fibre	Cum. Mcf	270,780	271,666	272,827	274,058	275,226	276,141	276,978	277,669	278,435	279,159	279,876	280,597	280,597	Cum. Mcf
31-36-66	Tbg. Pres.	228	222	223	220	220	213	214	210	210	219	213	214		Tbg. Pres.
O&G 479	Csg. Pres.	241	240	240	261	248	241	246	245	245	255	251	256		Csg. Pres.
	Therms	7,340	7,977	10,472	11,126	10,563	8,275	7,569	6,253	6,927	6,551	6,483	6,519	96,055	Therms
	Cum. Therms	1,323,495	1,331,472	1,341,944	1,353,070	1,363,633	1,371,908	1,379,477	1,385,730	1,392,657	1,399,208	1,405,691	1,412,210	1,412,210	Cum. Therms
	Btu/cf	900	900	902	904	904	904	904	904	904	904	904	904		Btu/cf
	Days Prod.	31	28	31	30	31	29	31	31	30	31	30	31	364	Days Prod.
Enerfin Resources	Mcf	1,667	1,133	1,330	1,847	2,093	2,150	2,107	1,520	1,817	1,843	1,724	1,025	20,256	Mcf
Longview Fibre	Cum. Mcf	424,872	426,005	427,335	429,182	431,275	433,425	435,532	437,052	438,869	440,712	442,436	443,461	443,461	Cum. Mcf
32-20-66	Tbg. Pres.														Tbg. Pres.
O&G 413	Csg. Pres.	212	209	204	113	73	62	66	166	42	46	40	34		Csg. Pres.
	Therms	16,554	11,256	13,199	18,319	20,765	21,322	20,903	15,074	18,021	18,281	17,105	10,171	200,970	Therms
	Cum. Therms	4,201,475	4,212,731	4,225,930	4,244,249	4,265,014	4,286,336	4,307,239	4,322,313	4,340,334	4,358,615	4,375,720	4,385,891	4,385,891	Cum. Therms
	Btu/cf	993	993	993	992	992	992	992	992	992	992	992	992		Btu/cf
	Days Prod.	30	28	29	25	31	30	31	28	30	31	30	31	354	Days Prod.

Production		1997												Production	
1997		Jan	Feb	Mar	Apr	May	Jun	Jul	Aug	Sep	Oct	Nov	Dec	Year Totals	1997
Enerfin Resources	Mcf	1,385	668	736	675	598	438	762	499	274	115	shut in	shut in	6,150	Mcf
Longview Fibre	Cum. Mcf	561,728	562,396	563,132	563,807	564,405	564,843	565,605	566,104	566,378	566,493			566,493	Cum. Mcf
43-32-66	Tbg. Pres.	225	218	211	117	82	69	78	85	28	22				Tbg. Pres.
O&G 478	Csg. Pres.	274	279	275	184	143	136	168	241	237	301				Csg. Pres.
	Therms	13,531	6,528	7,188	6,548	5,807	4,253	7,394	4,841	2,657	1,115			59,862	Therms
	Cum. Therms	5,473,145	5,479,673	5,486,861	5,493,409	5,499,216	5,503,469	5,510,863	5,515,704	5,518,361	5,519,476			5,519,476	Cum. Therms
	Btu/cf	977	977	977	972	970	970	970	970	970	964				Btu/cf
	Days Prod.	31	28	30	25	31	29	29	17	13	14	0		247	Days Prod.
Northwest Natural	Mcf	541	606	740	865	1,554	1,306	1,448	1,326	1,103	1,484	1,488	1,215	13,676	Mcf
Columbia County	Cum. Mcf	4,033,803	4,034,409	4,035,149	4,036,014	4,037,568	4,038,874	4,040,322	4,041,648	4,042,751	4,044,235	4,045,723	4,046,938	4,046,938	Cum. Mcf
13-34-75	Tbg. Pres.	147	145	145	144	141	132	141	140	145	142	141	143		Tbg. Pres.
O&G 226	Csg. Pres.	147	146	146	146	143	140	143	141	146	142	141	143		Csg. Pres.
	Therms	5,366	6,012	7,319	8,530	15,331	12,880	14,283	13,077	10,874	14,636	14,680	11,977	134,965	Therms
	Cum. Therms	38,786,235	38,792,247	38,799,566	38,808,096	38,823,427	38,836,307	38,850,590	38,863,667	38,874,541	38,889,177	38,903,857	38,915,834	38,915,834	Cum. Therms
	Btu/cf	992	992	989	986	986	986	986	986	986	986	986	986		Btu/cf
	Days Prod.	30	28	31	30	31	29	31	31	29	31	30	29	360	Days Prod.
Northwest Natural	Mcf	3,611	4,231	4,784	4,076	4,607	3,901	4,514	4,298	4,021	4,254	3,814	3,912	50,023	Mcf
Columbia County	Cum. Mcf	1,423,959	1,428,190	1,432,974	1,437,050	1,441,657	1,445,558	1,450,072	1,454,370	1,458,391	1,462,645	1,466,459	1,470,371	1,470,371	Cum. Mcf
43-33-75	Tbg. Pres.	138	132	121	121	124	121	125	119	127	119	119	113		Tbg. Pres.
O&G 471	Csg. Pres.	138	133	125	127	127	125	126	124	130	126	126	125		Csg. Pres.
	Therms	35,859	42,007	47,382	40,228	45,472	38,501	44,550	42,417	39,686	41,993	37,681	38,651	494,427	Therms
	Cum. Therms	14,074,671	14,116,678	14,164,060	14,204,288	14,249,760	14,288,261	14,332,811	14,375,228	14,414,914	14,456,907	14,494,588	14,533,239	14,533,239	Cum. Therms
	Btu/cf	993	993	990	987	987	987	987	987	987	987	988	988		Btu/cf
	Days Prod.	30	28	30	30	31	29	31	31	29	31	30	31	361	Days Prod.
Northwest Natural	Mcf	571	497	562	523	499	494	492	451	354	438	412	412	5,705	Mcf
Columbia County	Cum. Mcf	724,376	724,873	725,435	725,958	726,457	726,951	727,443	727,894	728,248	728,686	729,098	729,510	729,510	Cum. Mcf
44-27	Tbg. Pres.														Tbg. Pres.
O&G 407	Csg. Pres.	206	200	200	197	202	204	202	199	223	206	204	206		Csg. Pres.
	Therms	5,346	4,648	5,240	4,858	4,640	4,591	4,577	4,192	3,294	4,069	3,830	3,836	53,121	Therms
	Cum. Therms	6,556,508	6,561,156	6,566,396	6,571,254	6,575,894	6,580,485	6,585,062	6,589,254	6,592,548	6,596,617	6,600,447	6,604,283	6,604,283	Cum. Therms
	Btu/cf	935	935	933	930	930	930	930	930	930	930	930	930		Btu/cf
	Days Prod.	31	28	31	30	31	30	31	31	28	31	30	31	363	Days Prod.
Northwest Natural	Mcf	5,255	4,533	5,955	6,638	5,662	5,019	5,278	5,086	3,936	3,845	3,918	3,024	58,149	Mcf
Longview Fibre 12B-35	Cum. Mcf	1,209,075	1,213,608	1,219,563	1,226,201	1,231,863	1,236,882	1,242,160	1,247,246	1,251,182	1,255,027	1,258,945	1,261,969	1,261,969	Cum. Mcf
O&G 476	Tbg. Pres.	219	215	215	213	213	211	210	210	210	210	209	209		Tbg. Pres.
	Csg. Pres.	220	217	216	215	214	212	211	211	211	210	210	210		Csg. Pres.
	Therms	47,870	41,293	54,078	60,071	51,240	45,418	47,762	46,027	35,620	34,802	35,459	27,367	527,007	Therms
	Cum. Therms	11,181,306	11,222,599	11,276,677	11,336,748	11,387,988	11,433,406	11,481,168	11,527,195	11,562,815	11,597,617	11,633,076	11,660,443	11,660,443	Cum. Therms
	Btu/cf	911	911	908	905	905	905	905	905	905	905	905	905		Btu/cf
	Days Prod.	31	28	31	30	31	30	31	31	30	31	30	31	365	Days Prod.
TOTAL MCF FOR YEAR														1,380,509	
TOTAL CUMULATIVE MCF TO DATE, MIST GAS FIELD														84,220,726	

**Mist Gas Field
Production Figures
1998**

		Production												Production	
1998		Jan	Feb	Mar	Apr	May	Jun	Jul	Aug	Sep	Oct	Nov	Dec	Year Totals	1998
Enerfin Resources	Mcf	21,620	19,003	23,043	22,143	22,128	22,097	18,368	15,783	19,425	19,480	19,471	20,282	242,843	Mcf
CER 11-16-64	Cum. Mcf	1,639,339	1,658,342	1,681,385	1,703,528	1,725,656	1,747,753	1,766,121	1,781,904	1,801,329	1,820,809	1,840,280	1,860,562	1,860,562	Cum. Mcf
O&G 449	Tbg. Pres.	116	116	112	108	109	104	110	117	108	104	100	98		Tbg. Pres.
	Csg. Pres.	129	128	124	120	120	117	120	123	117	114	110	108		Csg. Pres.
	Therms	192,416	169,126	205,084	197,067	196,748	196,438	163,290	140,314	172,693	173,174	173,096	180,308	2,159,754	Therms
	Cum. Therms	14,546,601	14,715,727	14,920,811	15,117,878	15,314,626	15,511,064	15,674,354	15,814,668	15,987,361	16,160,535	16,333,631	16,513,939	16,513,939	Cum. Therms
	Btu/cf	890	890	890	890	889	889	889	889	889	889	889	889		Btu/cf
	Days Prod.	30	27	31	30	31	30	31	31	30	31	30	31	363	Days Prod.
Enerfin Resources	Mcf	25	19	shut in	32	shut in	shut in	abandoned	abandoned	abandoned	abandoned	abandoned	abandoned	76	Mcf
CER 13-01-55	Cum. Mcf	50,896	50,915	50,915	50,947									50,947	Cum. Mcf
O&G 436	Tbg. Pres.														Tbg. Pres.
	Csg. Pres.	206	204		208										Csg. Pres.
	Therms	196	160		264									620	Therms
	Cum. Therms	384,685	384,845	384,845	385,109									385,109	Cum. Therms
	Btu/cf	824	824		824										Btu/cf
	Days Prod.	29	4		7									40	Days Prod.
Enerfin Resources	Mcf	30,481	25,941	33,187	32,295	31,650	30,632	30,259	29,532	28,602	28,761	27,486	26,031	354,857	Mcf
CER 41-16-64	Cum. Mcf	2,955,409	2,981,350	3,014,537	3,046,832	3,078,482	3,109,114	3,139,373	3,168,905	3,197,507	3,226,268	3,253,754	3,279,785	3,279,785	Cum. Mcf
O&G 423	Tbg. Pres.														Tbg. Pres.
	Csg. Pres.	145	146	141	140	139	136	135	132	131	129	128	127		Csg. Pres.
	Therms	270,065	229,836	294,042	285,725	279,152	270,180	266,883	260,476	252,271	253,676	242,431	229,597	3,134,334	Therms
	Cum. Therms	26,068,917	26,298,753	26,592,795	26,878,520	27,157,672	27,427,852	27,694,735	27,955,211	28,207,482	28,461,158	28,703,589	28,933,186	28,933,186	Cum. Therms
	Btu/cf	886	886	886	885	882	882	882	882	882	882	882	882		Btu/cf
	Days Prod.	29	24	31	30	31	30	31	31	30	31	30	31	359	Days Prod.
Enerfin Resources	Mcf	shut in	shut in	shut in	shut in	shut in	shut in	abandoned	abandoned	abandoned	abandoned	abandoned	abandoned		Mcf
CFI 23-15-54	Cum. Mcf													440,262	Cum. Mcf
O&G 324	Tbg. Pres.														Tbg. Pres.
	Csg. Pres.														Csg. Pres.
	Therms														Therms
	Cum. Therms													9,965,708	Cum. Therms
	Btu/cf														Btu/cf
	Days Prod.														Days Prod.
Enerfin Resources	Mcf	412	448	399	326	156	shut in	542	368	264	321	310	383	3,929	Mcf
CFI 31-16-54	Cum. Mcf	599,097	599,545	599,944	600,270	600,426		600,968	601,336	601,600	601,921	602,231	602,614	602,614	Cum. Mcf
O&G 307	Tbg. Pres.	178	218	190	197	246		294	260	257	260	252	238		Tbg. Pres.
	Csg. Pres.	685	574	627	681	744		637	674	747	705	688	747		Csg. Pres.
	Therms	2,200	2,393	2,130	1,742	829		2,883	1,958	1,406	1,708	1,647	2,038	20,934	Therms
	Cum. Therms	12,685,168	12,687,561	12,689,691	12,691,433	12,692,262		12,695,145	12,697,103	12,698,509	12,700,217	12,701,864	12,703,902	12,703,902	Cum. Therms
	Btu/cf	534	534	534	534	532		532	532	532	532	532	532		Btu/cf
	Days Prod.	6	6	7	6	4		5	5	6	6	6	4	61	Days Prod.

		Production												Production	
1998		Jan	Feb	Mar	Apr	May	Jun	Jul	Aug	Sep	Oct	Nov	Dec	Year Totals	1998
Enerfin Resources	Mcf	4,824	4,654	5,293	4,892	5,247	4,441	4,960	5,459	4,547	4,483	3,864	3,810	56,474	Mcf
CFW 12-15-64	Cum. Mcf	1,301,087	1,305,741	1,311,034	1,315,926	1,321,173	1,325,614	1,330,574	1,336,033	1,340,580	1,345,063	1,348,927	1,352,737	1,352,737	Cum. Mcf
O&G 408	Tbg. Pres.														Tbg. Pres.
	Csg. Pres.	131	132	130	127	126	124	123	122	121	120	119	118		Csg. Pres.
	Therms	42,311	40,811	46,427	42,811	45,758	38,723	43,234	47,603	39,649	39,091	33,694	33,223	493,335	Therms
	Cum. Therms	11,405,528	11,446,339	11,492,766	11,535,577	11,581,335	11,620,058	11,663,292	11,710,895	11,750,544	11,789,635	11,823,329	11,856,552	11,856,552	Cum. Therms
	Btu/cf	877	877	877	875	872	872	872	872	872	872	872	872		Btu/cf
	Days Prod.	29	24	31	30	31	30	31	31	30	31	30	28	356	Days Prod.
Enerfin Resources	Mcf	13,493	15,473	14,774	13,133	14,310	10,693	14,868	12,847	12,551	12,515	12,272	10,600	157,529	Mcf
Columbia Co. 24-9-64	Cum. Mcf	1,250,770	1,266,243	1,281,017	1,294,150	1,308,460	1,319,153	1,334,021	1,346,868	1,359,419	1,371,934	1,384,206	1,394,806	1,394,806	Cum. Mcf
O&G 407	Tbg. Pres.														Tbg. Pres.
	Csg. Pres.	91	100	91	87	87	79	95	106	89	88	83	79		Csg. Pres.
	Therms	119,815	137,405	131,196	116,391	126,499	94,529	131,433	113,570	110,949	110,635	108,481	93,701	1,394,604	Therms
	Cum. Therms	11,053,852	11,191,257	11,322,453	11,438,844	11,565,343	11,659,872	11,791,305	11,904,875	12,015,824	12,126,459	12,234,940	12,328,641	12,328,641	Cum. Therms
	Btu/cf	888	888	888	887	884	884	884	884	884	884	884	884		Btu/cf
	Days Prod.	30	27	31	30	31	30	31	31	30	31	30	31	363	Days Prod.
Enerfin Resources	Mcf	107	shut in	shut in	shut in	shut in	shut in	shut in	shut in	shut in	shut in	539	557	1,203	Mcf
Columbia Co. 31-15-65	Cum. Mcf	712,198										712,737	713,294	713,294	Cum. Mcf
O&G 469	Tbg. Pres.	1										69	15		Tbg. Pres.
	Csg. Pres.	1										69	15		Csg. Pres.
	Therms	1,001										5,014	5,181	11,196	Therms
	Cum. Therms	6,657,567										6,662,581	6,667,762	6,667,762	Cum. Therms
	Btu/cf	931										930	930		Btu/cf
	Days Prod.	7										13	25	45	Days Prod.
Enerfin Resources	Mcf				redrilled 1998	5,350	15,497	11,240	6,422	1,056	4,229	477	44,271	44,271	Mcf
Columbia Co. 32-27-65	Cum. Mcf					5,350	20,847	32,087	38,509	39,565	43,794	44,271	44,271	44,271	Cum. Mcf
O&G 502 RD	Tbg. Pres.														Tbg. Pres.
	Csg. Pres.					464	408	325	243	294	242	284			Csg. Pres.
	Therms					50,876	147,375	106,896	61,067	10,048	40,219	4,537	421,018	421,018	Therms
	Cum. Therms					50,876	198,251	305,147	366,214	376,262	416,481	421,018	421,018	421,018	Cum. Therms
	Btu/cf					951	951	951	951	951	951	951	951		Btu/cf
	Days Prod.					11	31	31	30	5	30	8	146	146	Days Prod.
Enerfin Resources	Mcf	shut in	67	shut in	shut in	shut in	shut in	shut in	shut in	shut in	shut in	shut in	shut in	67	Mcf
Columbia Co. 34-31-65	Cum. Mcf		6,016											6,016	Cum. Mcf
O&G 458	Tbg. Pres.		140												Tbg. Pres.
	Csg. Pres.		516												Csg. Pres.
	Therms		655											655	Therms
	Cum. Therms		58,863											58,863	Cum. Therms
	Btu/cf		978												Btu/cf
	Days Prod.		5											5	Days Prod.

		Production												Production		
1998		Jan	Feb	Mar	Apr	May	Jun	Jul	Aug	Sep	Oct	Nov	Dec	Year Totals	1998	
Enerfin Resources	Mcf	18,583	13,915	18,437	18,152	19,148	19,857	18,639	20,647	21,413	18,992	20,610	20,979	229,372	Mcf	
Columbia Co. 42-8-54	Cum. Mcf	737,360	751,275	769,712	787,864	807,012	826,869	845,508	866,155	887,568	906,560	927,170	948,149	948,149	Cum. Mcf	
O&G 376	Tbg. Pres.														Tbg. Pres.	
	Csg. Pres.	444	505	478	473	464	449	470	435	426	455	447	440		Csg. Pres.	
	Therms	137,516	102,971	136,434	134,309	141,503	146,742	137,747	152,581	158,240	140,348	152,309	155,034	1,695,734	Therms	
	Cum. Therms	11,846,715	11,949,686	12,086,120	12,220,429	12,361,932	12,508,674	12,646,421	12,799,002	12,957,242	13,097,590	13,249,899	13,404,933	13,404,933	Cum. Therms	
	Btu/cf	740	740	740	740	739	739	739	739	739	739	739	739		Btu/cf	
	Days Prod.	29	24	31	30	31	30	30	31	30	30	30	31	357	Days Prod.	
Enerfin Resources	Mcf	650	13	408	79	shut in	shut in	shut in	shut in	shut in	shut in	shut in	shut in	1,150	Mcf	
Columbia Co. 44-8-64	Cum. Mcf	249,180	249,193	249,601	249,680									249,680	Cum. Mcf	
O&G 459	Tbg. Pres.	93	133	93	88										Tbg. Pres.	
	Csg. Pres.	112	123	132	134										Csg. Pres.	
	Therms	5,804	113	3,648	705									10,270	Therms	
	Cum. Therms	2,238,597	2,238,710	2,242,358	2,243,063									2,243,063	Cum. Therms	
	Btu/cf	893	893	893	893										Btu/cf	
	Days Prod.	29	1	30	8									68	Days Prod.	
Enerfin Resources	Mcf	5,754	5,619	7,336	7,385	7,406	7,187	1,917	4,785	5,027	5,189	4,968	4,760	67,333	Mcf	
Longview Fibre 12A-33-	Cum. Mcf	1,160,952	1,166,571	1,173,907	1,181,292	1,188,698	1,195,885	1,197,802	1,202,587	1,207,614	1,212,803	1,217,771	1,222,531	1,222,531	Cum. Mcf	
O&G 474	Tbg. Pres.	157	110	104	96	100	96	91	97	97	98	101	101		Tbg. Pres.	
	Csg. Pres.	236	210	227	211	214	201	204	201	215	220	223	213		Csg. Pres.	
	Therms	57,537	56,195	73,363	73,846	74,061	71,874	19,167	47,850	50,269	51,889	49,685	47,599	673,335	Therms	
	Cum. Therms	9,536,677	9,592,872	9,666,235	9,740,081	9,814,142	9,886,016	9,905,183	9,953,033	10,003,302	10,055,191	10,104,876	10,152,475	10,152,475	Cum. Therms	
	Btu/cf	1,000	1,000	1,000	1,000	1,000	1,000	1,000	1,000	1,000	1,000	1,000	1,000		Btu/cf	
	Days Prod.	31	26	31	30	31	30	9	31	30	31	30	29	339	Days Prod.	
Enerfin Resources	Mcf	738	780	669	694	1,030	36	shut in	shut in	shut in	204	46	shut in	4,197	Mcf	
Longview Fibre 31-36-6!	Cum. Mcf	281,335	282,115	282,784	283,478	284,508	284,544				284,748	284,794		284,794	Cum. Mcf	
O&G 478	Tbg. Pres.	221	211	212	213	214	223				215	205			Tbg. Pres.	
	Csg. Pres.	267	260	260	264	261	255				256	255			Csg. Pres.	
	Therms	6,674	7,055	6,044	6,271	9,280	324				1,842	418		37,908	Therms	
	Cum. Therms	1,418,884	1,425,939	1,431,983	1,438,254	1,447,534	1,447,858				1,449,700	1,450,118		1,450,118	Cum. Therms	
	Btu/cf	904	904	904	903	901	901				901	901			Btu/cf	
	Days Prod.	31	28	29	30	18	1				11	3		151	Days Prod.	
Enerfin Resources	Mcf	shut in	shut in	shut in	shut in	shut in	shut in	1,939	1,725	1,392	1,398	1,318	1,042	8,814	Mcf	
Longview Fibre 32-20-6!	Cum. Mcf							workover	445,400	447,125	448,517	449,915	451,233	452,275	452,275	Cum. Mcf
O&G 412	Tbg. Pres.							60	44	37	41	44	94		Tbg. Pres.	
	Csg. Pres.							181	162	159	144	143	210		Csg. Pres.	
	Therms							19,239	17,117	13,811	13,864	13,075	10,337	87,443	Therms	
	Cum. Therms							4,405,130	4,422,247	4,436,058	4,449,922	4,462,997	4,473,334	4,473,334	Cum. Therms	
	Btu/cf							992	992	992	992	992	992		Btu/cf	
	Days Prod.							24	31	30	30	30	28	173	Days Prod.	

Production		1998												Production	
1998		Jan	Feb	Mar	Apr	May	Jun	Jul	Aug	Sep	Oct	Nov	Dec	Year Totals	1998
Enerfin Resources	Mcf	766	13	169	shut in	shut in	shut in	shut in	shut in	shut in	shut in	533	202	1,683	Mcf
Longview Fibre 43-32-6	Cum. Mcf	567,259	567,272	567,441								567,974	568,176	568,176	Cum. Mcf
O&G 477	Tbg. Pres.	95	20	18								255	181		Tbg. Pres.
	Csg. Pres.	159	225	181								279	272		Csg. Pres.
	Therms	7,281	125	1,604								5,065	1,920	15,995	Therms
	Cum. Therms	5,526,757	5,526,882	5,527,077								5,532,142	5,534,062	5,534,062	Cum. Therms
	Btu/cf	950	950	950								950	950		Btu/cf
	Days Prod.	23	1	15								20	13	72	Days Prod.
Northwest Natural	Mcf	1,156	1,178	1,472	1,540	1,579	1,488	780	1,566	1,407	1,440	1,198	1,339	16,143	Mcf
Columbia Co. 13-34-75	Cum. Mcf	4,048,094	4,049,272	4,050,744	4,052,284	4,053,863	4,055,351	4,056,131	4,057,697	4,059,104	4,060,544	4,061,742	4,063,081	4,063,081	Cum. Mcf
O&G 225	Tbg. Pres.	143	140	140	135	137	131	138	135	124	125	114	134		Tbg. Pres.
	Csg. Pres.	143	141	141	136	137	132	138	136	128	127	132	136		Csg. Pres.
	Therms	11,406	11,617	14,520	15,176	15,545	14,636	7,678	15,411	13,841	14,167	11,795	13,176	158,968	Therms
	Cum. Therms	38,927,240	38,938,857	38,953,377	38,968,553	38,984,098	38,998,734	39,006,412	39,021,823	39,035,664	39,049,831	39,061,626	39,074,802	39,074,802	Cum. Therms
	Btu/cf	986	986	986	985	984	984	984	984	984	984	984	984		Btu/cf
	Days Prod.	26	24	31	30	31	30	19	31	30	31	30	31	344	Days Prod.
Northwest Natural	Mcf	3,066	3,322	3,888	3,737	3,797	3,496	2,009	4,251	3,601	3,685	3,530	3,929	42,311	Mcf
Columbia Co. 43-33-75	Cum. Mcf	1,473,437	1,476,759	1,480,647	1,484,384	1,488,181	1,491,677	1,493,686	1,497,937	1,501,538	1,505,223	1,508,753	1,512,682	1,512,682	Cum. Mcf
O&G 470	Tbg. Pres.	120	131	125	117	119	113	132	124	108	108	111	112		Tbg. Pres.
	Csg. Pres.	128	132	126	120	123	122	134	125	121	121	123	120		Csg. Pres.
	Therms	30,292	32,818	38,414	36,909	37,473	34,506	19,829	41,959	35,548	36,369	34,844	38,779	417,740	Therms
	Cum. Therms	14,563,531	14,596,349	14,634,763	14,671,672	14,709,145	14,743,651	14,763,480	14,805,439	14,840,987	14,877,356	14,912,200	14,950,979	14,950,979	Cum. Therms
	Btu/cf	988	988	988	988	987	987	987	987	987	987	987	987		Btu/cf
	Days Prod.	28	24	31	30	31	30	20	31	30	31	30	31	347	Days Prod.
Northwest Natural	Mcf	382	351	401	404	426	408	439	434	395	383	387	403	4,813	Mcf
Columbia Co. 44-27	Cum. Mcf	729,892	730,243	730,644	731,048	731,474	731,882	732,321	732,755	733,150	733,533	733,920	734,323	734,323	Cum. Mcf
O&G 406	Tbg. Pres.														Tbg. Pres.
	Csg. Pres.	206	204	204	200	210	208	206	205	206	209	210	208		Csg. Pres.
	Therms	3,558	3,270	3,735	3,754	3,957	3,796	4,081	4,033	3,680	3,561	3,603	3,746	44,774	Therms
	Cum. Therms	6,607,841	6,611,111	6,614,846	6,618,600	6,622,557	6,626,353	6,630,434	6,634,467	6,638,147	6,641,708	6,645,311	6,649,057	6,649,057	Cum. Therms
	Btu/cf	930	930	930	930	930	930	930	930	930	930	930	930		Btu/cf
	Days Prod.	29	27	31	30	31	30	31	31	30	31	30	31	362	Days Prod.
Northwest Natural	Mcf	2,779	2,818	3,038	3,122	2,142	1,181	2,276	2,827	2,118	1,182	753	1,249	25,485	Mcf
Longview Fibre 12B-35	Cum. Mcf	1,264,748	1,267,566	1,270,604	1,273,726	1,275,868	1,277,049	1,279,325	1,282,152	1,284,270	1,285,452	1,286,205	1,287,454	1,287,454	Cum. Mcf
O&G 476	Tbg. Pres.	209	208	206	203	205	208	207	206	207	208	209	209		Tbg. Pres.
	Csg. Pres.	209	209	206	204	206	208	208	207	208	209	209	210		Csg. Pres.
	Therms	25,149	25,499	27,500	28,252	19,362	10,678	20,581	25,552	19,145	10,684	6,810	11,292	230,504	Therms
	Cum. Therms	11,685,592	11,711,091	11,738,591	11,766,843	11,767,091	11,777,769	11,798,350	11,823,902	11,843,047	11,853,731	11,860,541	11,871,833	11,871,833	Cum. Therms
	Btu/cf	905	905	905	905	904	904	904	904	904	904	904	904		Btu/cf
	Days Prod.	29	27	31	30	31	30	31	31	30	22	25	26	343	Days Prod.
TOTAL MCF FOR YEAR														1,262,550	
TOTAL CUM. MACF TO DATE, MIST GAS FIELD														85,483,276	

**Mist Gas Field
Production Figures
1999**

		Production												Production	
1999		Jan	Feb	Mar	Apr	May	Jun	Jul	Aug	Sep	Oct	Nov	Dec	Year Totals	1999
Enerfin Resources	Mcf	18,837	16,716	18,177	17,127	17,553	16,717	16,865	16,657	15,901	15,823	15,049	14,873	200,295	Mcf
CER 11-16-64	Cum. Mcf	1,879,399	1,896,115	1,914,292	1,931,419	1,948,972	1,965,689	1,982,554	1,999,211	2,015,112	2,030,935	2,045,984	2,060,857	2,060,857	Cum. Mcf
O&G 449	Tbg. Pres.	99	96	97	95	94	92	91	90	89	87	86	84		Tbg. Pres.
	Csg. Pres.	107	106	105	104	103	101	101	99	98	96	94	92		Csg. Pres.
	Therms	167,464	148,606	161,599	152,262	156,050	148,615	149,929	148,086	141,363	140,671	133,793	132,227	1,780,665	Therms
	Cum. Therms	16,681,403	16,830,009	16,991,608	17,143,870	17,299,920	17,448,535	17,598,464	17,746,550	17,887,913	18,028,584	18,162,377	18,294,604	18,294,604	Cum. Therms
	Btu/cf	889	889	899	889	889	889	889	889	889	889	889	889		Btu/cf
	Days Prod.	31	28	31	30	31	30	31	31	30	31	30	31	365	Days Prod.
Enerfin Resources	Mcf	26,996	21,368	27,579	27,346	29,167	29,446	30,140	30,588	28,777	27,338	26,934	27,473	333,152	Mcf
CER 41-16-64	Cum. Mcf	3,306,781	3,328,149	3,355,728	3,383,074	3,412,241	3,441,687	3,471,827	3,502,415	3,531,192	3,558,530	3,585,464	3,612,937	3,612,937	Cum. Mcf
O&G 423	Tbg. Pres.														Tbg. Pres.
	Csg. Pres.	126	125	122	119	118	116	114	112	110	110	107	116		Csg. Pres.
	Therms	238,561	189,107	243,998	242,020	258,134	260,597	266,741	270,700	254,676	241,950	238,366	243,137	2,947,987	Therms
	Cum. Therms	29,171,747	29,360,854	29,604,852	29,846,872	30,105,006	30,365,603	30,632,344	30,903,044	31,157,720	31,399,670	31,638,036	31,881,173	31,881,173	Cum. Therms
	Btu/cf	884	885	885	885	885	885	885	885	885	885	885	885		Btu/cf
	Days Prod.	31	25	31	30	31	30	31	31	30	31	30	31	362	Days Prod.
Enerfin Resources	Mcf	250	57	181	221	229	240	332	276	236	172	121	106	2,421	Mcf
CFI 31-16-54	Cum. Mcf	602,864	602,921	603,102	603,323	603,552	603,792	604,124	604,400	604,636	604,808	604,929	605,035	605,035	Cum. Mcf
O&G 307	Tbg. Pres.	238	250	280	320	340	278	290	290	277	278	300	279		Tbg. Pres.
	Csg. Pres.	633	770	785	630	620	658	550	565	567	678	600	642		Csg. Pres.
	Therms	1,334	303	967	1,176	1,220	1,279	1,769	1,468	1,256	918	596	565	12,851	Therms
	Cum. Therms	12,705,236	12,705,539	12,706,506	12,707,682	12,708,902	12,710,181	12,711,950	12,713,418	12,714,674	12,715,592	12,716,188	12,716,753	12,716,753	Cum. Therms
	Btu/cf	532	532	532	532	532	532	532	532	532	532	532	532		Btu/cf
	Days Prod.	6	1	2	2	2	3	3	3	3	3	2	1	31	Days Prod.
Enerfin Resources	Mcf	4,095	1,943	2,843	2,743	2,846	2,606	2,416	2,092	1,923	1,771	2,516	2,757	30,551	Mcf
CFW 12-15-64	Cum. Mcf	1,356,832	1,358,775	1,361,618	1,364,361	1,367,207	1,369,813	1,372,229	1,374,321	1,376,244	1,378,015	1,380,531	1,383,288	1,383,288	Cum. Mcf
O&G 408	Tbg. Pres.														Tbg. Pres.
	Csg. Pres.	118	115	130	124	119	121	117	117	113	115	107	110		Csg. Pres.
	Therms	35,778	17,006	24,882	24,005	24,912	22,810	21,149	18,312	16,832	15,505	22,020	24,129	267,340	Therms
	Cum. Therms	11,892,330	11,909,336	11,934,218	11,958,223	11,983,135	12,005,945	12,027,094	12,045,406	12,062,238	12,077,743	12,099,763	12,123,892	12,123,892	Cum. Therms
	Btu/cf	874	875	875	875	875	875	875	875	875	875	875	875		Btu/cf
	Days Prod.	31	18	31	30	31	30	31	31	30	31	30	31	355	Days Prod.
Enerfin Resources	Mcf										new well	27,545	31,493	59,038	Mcf
Columbia Co. 14-32-75	Cum. Mcf											27,545	59,038	59,038	Cum. Mcf
O&G 522	Tbg. Pres.														Tbg. Pres.
	Csg. Pres.											839	796		Csg. Pres.
	Therms											276,281	315,879	592,160	Therms
	Cum. Therms											276,281	592,160	592,160	Cum. Therms
	Btu/cf											1003	1003		Btu/cf
	Days Prod.											28	31	59	Days Prod.

		Production												Production	
1999		Jan	Feb	Mar	Apr	May	Jun	Jul	Aug	Sep	Oct	Nov	Dec	Year Totals	1999
Enerfin Resources	Mcf	12,152	10,652	10,806	9,996	10,218	10,027	10,209	9,599	8,984	9,702	9,254	9,224	120,823	Mcf
Columbia Co. 24-9-64	Cum. Mcf	1,406,958	1,417,610	1,428,416	1,438,412	1,448,630	1,458,657	1,468,866	1,478,465	1,487,449	1,497,151	1,506,405	1,515,629	1,515,629	Cum. Mcf
O&G 407	Tbg. Pres.														Tbg. Pres.
	Csg. Pres.	84	81	82	82	81	89	91	90	89	89	88	86		Csg. Pres.
	Therms	107,669	94,596	95,958	88,773	90,737	89,044	90,662	85,240	79,784	86,156	82,181	81,916	1,072,716	Therms
	Cum. Therms	12,436,310	12,530,906	12,626,864	12,715,637	12,806,374	12,895,418	12,986,080	13,071,320	13,151,104	13,237,260	13,319,441	13,401,357	13,401,357	Cum. Therms
	Btu/cf	886	888	888	888	888	888	888	888	888	888	888	888		Btu/cf
	Days Prod.	31	28	31	30	31	30	31	31	30	31	30	31	365	Days Prod.
Enerfin Resources	Mcf	92	128	49	131	242	25	289						956	Mcf
Columbia Co. 31-15-65	Cum. Mcf	713,386	713,514	713,563	713,694	713,936	713,961	714,250						714,250	Cum. Mcf
O&G 469	Tbg. Pres.	33	16	40	50	8	94	92	shut in						Tbg. Pres.
	Csg. Pres.	33	16	40	50	186	216	152							Csg. Pres.
	Therms	855	1,200	459	1228	2256	240	2700						8,938	Therms
	Cum. Therms	6,668,617	6,669,817	6,670,276	6,671,504	6,673,760	6,674,000	6,676,700						6,676,700	Cum. Therms
	Btu/cf	931	932	932	932	932	932	932							Btu/cf
	Days Prod.	5	8	4	7	5	5	13						47	Days Prod.
Enerfin Resources	Mcf	587	727	0	0	1361	182	265	293	217	154	281	113	4,180	Mcf
Columbia County 32-27-	Cum. Mcf	44,858	45,585	45,585	45,585	46,946	47,128	47,393	47,686	47,903	48,057	48,338	48,451	48,451	Cum. Mcf
O&G 502 RD	Tbg. Pres.														Tbg. Pres.
	Csg. Pres.	371	296			341	228	264	337	252	242	294			Csg. Pres.
	Therms	5,568	6,896			12,905	1,731	2,518	2,779	2,060	1,467	2,666	1,072	39,662	Therms
	Cum. Therms	426,586	433,482	433,482	433,482	446,387	448,118	450,636	453,415	455,475	456,942	459,608	460,680	460,680	Cum. Therms
	Btu/cf	949	948			948	948	948	948	948	948	948	948		Btu/cf
	Days Prod.	8	9			16	4	4	3	5	4	5	2	60	Days Prod.
Enerfin Resources	Mcf	shut in													Mcf
Columbia Co. 34-31-65	Cum. Mcf														Cum. Mcf
O&G 458	Tbg. Pres.								plugged						Tbg. Pres.
	Csg. Pres.														Csg. Pres.
	Therms														Therms
	Cum. Therms														Cum. Therms
	Btu/cf														Btu/cf
	Days Prod.														Days Prod.
Enerfin Resources	Mcf	21,797	20,790	19,343	18,139	20,891	19,000	17,498	16,449	17,349	17,982	18,480	20,141	227,859	Mcf
Columbia Co. 42-8-54	Cum. Mcf	969,946	990,736	1,010,079	1,028,218	1,049,109	1,068,109	1,085,607	1,102,056	1,119,405	1,137,387	1,155,867	1,176,008	1,176,008	Cum. Mcf
O&G 376	Tbg. Pres.														Tbg. Pres.
	Csg. Pres.	435	402	460	450	415	422	420	432	443	443	430	431		Csg. Pres.
	Therms	161,221	153,849	143,140	134,236	154,594	140,608	129,491	121,728	128,390	133,069	136,759	149,050	1,686,135	Therms
	Cum. Therms	13,566,154	13,720,003	13,863,143	13,997,379	14,151,973	14,292,581	14,422,072	14,543,800	14,672,190	14,805,259	14,942,018	15,091,068	15,091,068	Cum. Therms
	Btu/cf	740	740	740	740	740	740	740	740	740	740	740	740		Btu/cf
	Days Prod.	31	28	31	30	31	30	31	31	30	31	30	31	365	Days Prod.

		Production 1999												Production 1999					
		Jan	Feb	Mar	Apr	May	Jun	Jul	Aug	Sep	Oct	Nov	Dec	Year Totals					
Enerfin Resources	Mcf	shut in														Mcf			
Columbia Co. 44-8-64	Cum. Mcf															Cum. Mcf			
O&G 459	Tbg. Pres.															Tbg. Pres.			
	Csg. Pres.	plugged														Csg. Pres.			
	Therms															Therms			
	Cum. Therms															Cum. Therms			
	Btu/cf															Btu/cf			
	Days Prod.															Days Prod.			
Enerfin Resources	Mcf	new well	9,107	30,166	28,157	29,077	27,260	28,095	1,857	14,503	25,333	23,828	24,148	241,531	Mcf				
John Hancock 22-27-64	Cum. Mcf		9,107	39,273	67,430	96,507	123,767	151,862	153,719	168,222	193,555	217,383	241,531	241,531	Cum. Mcf				
O&G 514	Tbg. Pres.														Tbg. Pres.				
	Csg. Pres.		585	538	516	497		477	475	523	485	447	501		Csg. Pres.				
	Therms		78,321	259,429	242,158	250,067	234,444	241,623	15,970	124,734	217,869	204,931	207,679	2,077,225	Therms				
	Cum. Therms		78,321	337,750	579,908	829,975	1,064,419	1,306,042	1,322,012	1,446,746	1,664,615	1,869,546	2,077,225	2,077,225	Cum. Therms				
	Btu/cf		860	860	860	860	860	860	860	860	860	860	860	860	Btu/cf				
	Days Prod.		10	31	30	31	30	31	3	17	31	30	31	275	Days Prod.				
Enerfin Resources	Mcf	new well	6,432	22,200	17,436	11,269	15,260	12,680	711	1,215	14,103	12,624	11,886	125,816	Mcf				
John Hancock 32-27-64	Cum. Mcf		6,432	28,632	46,068	57,337	72,597	85,277	85,988	87,203	101,306	113,930	125,816	125,816	Cum. Mcf				
O&G 515	Tbg. Pres.														Tbg. Pres.				
	Csg. Pres.		577	522	474	471	228	455	383	555	516	434	476		Csg. Pres.				
	Therms		54,480	188,037	147,686	95,449	129,259	107,402	6,024	10,299	119,455	106,931	100,681	1,065,703	Therms				
	Cum. Therms		54,480	242,517	390,203	485,652	614,911	722,313	728,337	738,636	858,091	965,022	1,065,703	1,065,703	Cum. Therms				
	Btu/cf		847	847	847	847	847	847	847	847	847	847	847	847	Btu/cf				
	Days Prod.		9	31	30	23	30	31	3	3	31	30	31	252	Days Prod.				
Enerfin Resources	Mcf	6,278	6,031	6,582	6,051	6,614	6,768	6,678	6,233	4,940	5,259	6,121	6,044	73,599	Mcf				
Longview Fibre 12A-33-	Cum. Mcf	1,228,809	1,234,840	1,241,422	1,247,473	1,254,087	1,260,855	1,267,533	1,273,766	1,278,706	1,283,965	1,290,086	1,296,130	1,296,130	Cum. Mcf				
O&G 474	Tbg. Pres.	110	111	110	112	118	111	113	113	165	158	133	126		Tbg. Pres.				
	Csg. Pres.	184	165	167	171	184	174	176	176	233	218	190	183		Csg. Pres.				
	Therms	62,813	60,375	65,886	60,570	66,205	67,747	66,848	62,397	49,453	52,646	61,279	60,505	736,724	Therms				
	Cum. Therms	10,215,288	10,275,663	10,341,549	10,402,119	10,468,324	10,536,071	10,602,919	10,665,316	10,714,769	10,767,415	10,828,694	10,889,199	10,889,199	Cum. Therms				
	Btu/cf	1001	1001	1001	1001	1001	1001	1001	1001	1001	1001	1001	1001	1001	Btu/cf				
	Days Prod.	31	28	31	30	31	30	31	31	30	30	30	31	364	Days Prod.				
Enerfin Resources	Mcf	65	15															80	Mcf
Longview Fibre 31-36-64	Cum. Mcf	284,859	284,874															284,874	Cum. Mcf
O&G 478	Tbg. Pres.	201	204	shut in															Tbg. Pres.
	Csg. Pres.	244	257	plugged															Csg. Pres.
	Therms	588	142															730	Therms
	Cum. Therms	1,450,706	1,450,848															1,450,848	Cum. Therms
	Btu/cf	902	903																Btu/cf
	Days Prod.	17	5															22	Days Prod.

Production														Production	
1999		Jan	Feb	Mar	Apr	May	Jun	Jul	Aug	Sep	Oct	Nov	Dec	Year Totals	1999
Enerfin Resources	Mcf	1,277	1,130	1,129	1,069	1,240	895	1,170	911	424	586	492	322	10,645	Mcf
Longview Fibre 32-20-61	Cum. Mcf	453,552	454,682	455,811	456,880	458,120	459,015	460,185	461,096	461,520	462,106	462,598	462,920	473,565	Cum. Mcf
O&G 412	Tbg. Pres.	58	53	54	82	31	57	57	122	241	244	255	112		Tbg. Pres.
	Csg. Pres.	157	139	174	157	140	141	112	187	342	370	408	208		Csg. Pres.
	Therms	12,672	11,217	11,203	10,604	12,315	8,880	11,614	9,041	4,214	5,816	4,911	3,194	105,681	Therms
	Cum. Therms	4,486,006	4,497,223	4,508,426	4,519,030	4,531,345	4,540,225	4,551,839	4,560,880	4,565,094	4,570,910	4,575,821	4,579,015	4,579,015	Cum. Therms
	Btu/cf	992	992	992	992	992	992	992	992	992	992	992	992		Btu/cf
	Days Prod.	31	28	31	30	31	24	31	31	27	31	30	31	356	Days Prod.
Enerfin Resources	Mcf	84	0	0	0	125	558	60						827	Mcf
Longview Fibre 43-32-61	Cum. Mcf	568,260	568,260	568,260	568,260	568,385	568,943	569,003						569,003	Cum. Mcf
O&G 477	Tbg. Pres.	77				310	112	85	plugged						Tbg. Pres.
	Csg. Pres.	302				317	286	266							Csg. Pres.
	Therms	813				1,211	5,403	586						8,013	Therms
	Cum. Therms	5,534,875	5,534,875	5,534,875	5,534,875	5,536,086	5,541,489	5,542,075						5,542,075	Cum. Therms
	Btu/cf	959				967	967	967							Btu/cf
	Days Prod.	4				3	19	4						30	Days Prod.
Northwest Natural	Mcf	1,457	1,250	1,228	1,089	1,116	983	952	819	11		606	1,223	10,734	Mcf
Columbia Co. 13-34-75	Cum. Mcf	4,064,538	4,065,788	4,067,016	4,068,105	4,069,221	4,070,204	4,071,156	4,071,975	4,071,986	4,071,986	4,072,592	4,073,815	4,073,815	Cum. Mcf
O&G 225	Tbg. Pres.	124	115	104	102	106	94	106	128	140		141	138		Tbg. Pres.
	Csg. Pres.	133	130	128	129	129	126	128	135	140		141	139		Csg. Pres.
	Therms	14,352	12,335	12,116	10,747	11,012	9,693	9,393	8,080	113		5,979	12,062	105,882	Therms
	Cum. Therms	39,089,154	39,101,489	39,113,605	39,124,352	39,135,364	39,145,057	39,154,450	39,162,530	39,162,643		5,979	18,041	39,180,684	Cum. Therms
	Btu/cf	985	986	986	986	986	986	986	986	986		986	986		Btu/cf
	Days Prod.	31	28	31	30	31	30	29	29	1		11	31	282	Days Prod.
Northwest Natural	Mcf	3,823	3,311	3,533	3,691	3,780	3,404	3,768	3,797	351		769	1,396	31,623	Mcf
Columbia Co. 43-33-75	Cum. Mcf	1,516,505	1,519,816	1,523,349	1,527,040	1,530,820	1,534,224	1,537,992	1,541,789	1,542,140	1,542,140	1,542,909	1,544,305	1,544,305	Cum. Mcf
O&G 470	Tbg. Pres.	94	94	93	103	109	95	104	108	148		140	137		Tbg. Pres.
	Csg. Pres.	119	120	120	121	122	120	118	117	152		140	138		Csg. Pres.
	Therms	37,758	32,719	34,909	36,471	37,355	33,637	37,239	37,518	3,470		7,599	13,798	312,473	Therms
	Cum. Therms	14,988,737	15,021,456	15,056,365	15,092,836	15,130,191	15,163,828	15,201,067	15,238,585	15,242,055	15,242,055	15,249,654	15,263,452	15,263,452	Cum. Therms
	Btu/cf	988	988	988	988	988	988	988	988	988		988	988		Btu/cf
	Days Prod.	31	28	31	30	31	30	29	30	3		12	30	285	Days Prod.
Northwest Natural	Mcf	407	346	326	324	346	339	334	278	195	202	274	280	3,651	Mcf
Columbia Co. 44-27-65	Cum. Mcf	734,730	735,076	735,402	735,726	736,072	736,411	736,745	737,023	737,218	737,420	737,694	737,974	737,974	Cum. Mcf
O&G 406	Tbg. Pres.									101					Tbg. Pres.
	Csg. Pres.	205	210	221	202	220	217	216	220	218	237	235	236		Csg. Pres.
	Therms	3,783	3,219	3,038	3,011	3,224	3,156	3,115	2,594	1,823	2,720	2,551	2,606	34,840	Therms
	Cum. Therms	6,652,840	6,656,059	6,659,097	6,662,108	6,665,332	6,668,488	6,671,603	6,674,197	6,676,020	6,678,740	6,681,291	6,683,897	6,683,897	Cum. Therms
	Btu/cf	930	930	930	930	930	930	930	930	930	930	930	930		Btu/cf
	Days Prod.	31	28	30	30	31	30	31	31	30	31	30	31	364	Days Prod.

		Production 1999												Production 1999	
		Jan	Feb	Mar	Apr	May	Jun	Jul	Aug	Sep	Oct	Nov	Dec	Year Totals	
Northwest Natural	Mcf	556	0	0	0	7	73	250	162	169		1,039	2,188	4,444	Mcf
Longview Fibre 12B-35-	Cum. Mcf	1,288,010	1,288,010	1,288,010	1,288,010	1,288,017	1,288,090	1,288,340	1,288,502	1,288,671	1,288,671	1,289,710	1,291,898	1,291,898	Cum. Mcf
O&G 476	Tbg. Pres.	210				214	215	215	216	216	216	217	216		Tbg. Pres.
	Csg. Pres.	210				215	215	216	216	219		218	217		Csg. Pres.
	Therms	5,029				68	667	2,268	1,472	1,531		9,399	19,791	40,225	Therms
	Cum. Therms	11,876,862	11,876,862	11,876,862	11,876,862	11,876,930	11,877,597	11,879,865	11,881,337	11,882,868	11,882,868	11,892,267	11,912,058	11,912,058	Cum. Therms
	Btu/cf	904				904	904	904	904	904		904	904		Btu/cf
	Days Prod.	31				1	7	19	20	19		14	31	142	Days Prod.
Enerfin Resources	Mcf							new well		11,543	11,196	11,981	12,386	47,106	Mcf
CC 11-34-75	Cum. Mcf									11,543	22,739	34,720	47,106	47,106	Cum. Mcf
O&G 524	Tbg. Pres.														Tbg. Pres.
	Csg. Pres.									682	630	567	519		Csg. Pres.
	Therms									103,431	100,318	107,356	110,984	422,089	Therms
	Cum. Therms									103,431	203,749	311,105	422,089	422,089	Cum. Therms
	Btu/cf									836	896	896	896		Btu/cf
	Days Prod.									28	31	30	31	120	Days Prod.
Enerfin Resources	Mcf							new well		2,836	20,109	2,441		25,386	Mcf
CER 14-26-64	Cum. Mcf									2,836	22,945	25,386		25,386	Cum. Mcf
O&G 461	Tbg. Pres.									574	444	310			Tbg. Pres.
	Csg. Pres.									603	543	495			Csg. Pres.
	Therms									24,139	171,129	20,781		216,049	Therms
	Cum. Therms									24,139	195,268	216,049		216,049	Cum. Therms
	Btu/cf									85	851	851			Btu/cf
	Days Prod.									3	31	10		44	Days Prod.

TOTAL MCF FOR YEAR 1,554,717
TOTAL CUM. MCF TO DATE, MIST GAS FIELD 87,037,993

**Mist Gas Field
Production Figures
2000**

		Production													Production	
		2000	Jan	Feb	Mar	Apr	May	Jun	Jul	Aug	Sep	Oct	Nov	Dec	Year Totals	2000
Enerfin Resources	Mcf		temporarily abandoned													Mcf
BP 14-26-64RD	Cum. Mcf	25,386	25,386	25,386	25,386	25,386	25,386	25,386	25,386	25,386	25,386	25,386	25,386	25,386	25,386	Cum. Mcf
O&G 461	Tbg. Pres.															Tbg. Pres.
	Csg. Pres.															Csg. Pres.
	Therms															Therms
	Cum. Therms	216,049	216,049	216,049	216,049	216,049	216,049	216,049	216,049	216,049	216,049	216,049	216,049	216,049	216,049	Cum. Therms
	Btu/cf															Btu/cf
	Days Prod.															Days Prod.
Enerfin Resources	Mcf	15,939	14,814	15,487	14,683	14,651	12,846	13,586	13,705	13,615	13,329	13,007	13,492	169,154		Mcf
CER 11-16-64	Cum. Mcf	2,076,796	2,091,610	2,107,097	2,121,780	2,136,431	2,149,277	2,162,863	2,176,568	2,190,183	2,203,512	2,216,519	2,230,011	2,230,011		Cum. Mcf
O&G 449	Tbg. Pres.	81	79	78	77	77	76	74	74	72	71	70	67			Tbg. Pres.
	Csg. Pres.	90	88	86	84	84	83	82	82	79	77	74	72			Csg. Pres.
	Therms	141,703	131,762	137,838	130,686	130,399	114,332	120,920	121,977	121,175	118,631	115,769	120,084	1,505,276		Therms
	Cum. Therms	18,436,307	18,568,069	18,705,907	18,836,593	18,966,992	19,081,324	19,202,244	19,324,221	19,445,396	19,564,027	19,679,796	19,799,880	19,799,880		Cum. Therms
	Btu/cf	889	890	890	890	890	890	890	890	890	890	890	890			Btu/cf
	Days Prod.	31	29	31	30	31	28	30	31	30	31	30	31	363		Days Prod.
Enerfin Resources	Mcf	27,393	25,383	26,295	23,664	25,214	23,764	22,147	21,700	23,192	21,977	21,010	22,282	284,021		Mcf
CER 41-16-64	Cum. Mcf	3,640,330	3,665,713	3,692,008	3,715,672	3,740,886	3,764,650	3,786,797	3,808,497	3,831,689	3,853,666	3,874,676	3,896,958	3,896,958		Cum. Mcf
O&G 423	Tbg. Pres.															Tbg. Pres.
	Csg. Pres.	103	101	100	99	97	94	93	89	87	82	80	83			Csg. Pres.
	Therms	242,437	224,737	232,978	209,671	233,408	210,552	196,233	192,266	205,484	194,722	186,151	197,425	2,526,064		Therms
	Cum. Therms	32,123,610	32,348,347	32,581,325	32,790,996	33,024,404	33,234,956	33,431,189	33,623,455	33,828,939	34,023,661	34,209,812	34,407,237	34,407,237		Cum. Therms
	Btu/cf	885	885	886	886	886	886	886	886	886	886	886	886			Btu/cf
	Days Prod.	31	29	31	30	31	30	30	31	30	31	30	31	365		Days Prod.
Enerfin Resources	Mcf		297	386	151	340	191	157	338	227	132	228	28	2,475		Mcf
CFI 31-16-54	Cum. Mcf	605,035	605,332	605,718	605,869	606,209	606,400	606,557	606,895	607,122	607,254	607,482	607,510	607,510		Cum. Mcf
O&G 307	Tbg. Pres.		280	273	313	315	270	260	286	289	255	313	285			Tbg. Pres.
	Csg. Pres.		540	720	718	733	771	680	724	704	770	580	770			Csg. Pres.
	Therms		1,584	2,061	811	1,820	1,023	840	1,810	1,216	710	1,217	154	13,246		Therms
	Cum. Therms	12,716,753	12,718,337	12,720,398	12,721,209	12,723,029	12,724,052	12,724,892	12,726,702	12,727,918	12,728,628	12,729,845	12,729,999	12,729,999		Cum. Therms
	Btu/cf		534	534	534	534	534	534	534	534	534	534	534			Btu/cf
	Days Prod.		2	4	3	4	5	2	4	4	2	4	2	36		Days Prod.
Enerfin Resources	Mcf	3,076	2,761	2,874	2,647	2,722	2,640	2,505	2,570	2,603	2,625	2,369	2,597	31,989		Mcf
CFW 12-15-64	Cum. Mcf	1,386,364	1,389,125	1,391,999	1,394,646	1,397,368	1,400,008	1,402,513	1,405,083	1,407,686	1,410,311	1,412,680	1,415,277	1,415,277		Cum. Mcf
O&G 408	Tbg. Pres.															Tbg. Pres.
	Csg. Pres.	107	103	101	101	100	100	101	95	94	88	88	85			Csg. Pres.
	Therms	26,922	24,164	25,158	23,165	23,824	23,107	21,924	22,494	22,781	22,979	20,737	22,730	279,985		Therms
	Cum. Therms	12,150,814	12,174,978	12,200,136	12,223,301	12,247,125	12,270,232	12,292,156	12,314,650	12,337,431	12,360,410	12,381,147	12,403,877	12,403,877		Cum. Therms
	Btu/cf	875	875	875	875	875	875	875	875	875	875	875	875			Btu/cf
	Days Prod.	31	29	31	30	31	30	30	31	30	31	29	31	364		Days Prod.

		Production												Production		
		2000	Jan	Feb	Mar	Apr	May	Jun	Jul	Aug	Sep	Oct	Nov	Dec	Year Totals	2000
Enerfin Resources	Mcf		12,242	9,573	10,359	11,215	10,683	9,902	10,702	12,126	11,644	13,243	11,456	10,249	133,394	Mcf
CC 11-34-75	Cum. Mcf		59,348	68,921	79,280	90,495	101,178	111,080	121,782	133,908	145,552	158,795	170,251	180,500	180,500	Cum. Mcf
O&G 524	Tbg. Pres.															Tbg. Pres.
	Csg. Pres.		545	536	494	464	445	439	513	513	460	499	465	425		Csg. Pres.
	Therms		109,690	85,836	92,921	100,596	95,826	88,821	95,997	108,772	104,454	118,789	102,766	91,939	1,196,407	Therms
	Cum. Therms		531,779	617,615	710,536	811,132	906,958	995,779	1,091,776	1,200,548	1,305,002	1,423,791	1,526,557	1,618,496	1,618,496	Cum. Therms
	Btu/cf		896	897	897	798	897	897	897	897	897	897	897	897		Btu/cf
	Days Prod.		31	29	31	30	31	30	29	31	30	31	30	31	364	Days Prod.
Enerfin Resources	Mcf		33,200	33,302	35,033	31,418	30,108	28,691	28,782	31,100	30,730	29,234	26,150	24,524	362,272	Mcf
Columbia Co. 14-32-75	Cum. Mcf		92,238	125,540	160,573	191,991	222,099	250,790	279,572	310,672	341,402	370,636	396,786	421,310	421,310	Cum. Mcf
O&G 522	Tbg. Pres.															Tbg. Pres.
	Csg. Pres.		681	667	640	600	561	555	586	574	531	519	487	461		Csg. Pres.
	Therms		333,005	334,022	351,380	315,127	301,986	287,777	288,686	311,940	308,227	293,215	262,295	245,986	3,633,646	Therms
	Cum. Therms		925,165	1,259,187	1,610,567	1,925,694	2,227,680	2,515,457	2,804,143	3,116,083	3,424,310	3,717,525	3,979,820	4,225,806	4,225,806	Cum. Therms
	Btu/cf		1,003	1,003	1,003	1,003	1,003	1,003	1,003	1,003	1,003	1,003	1,003	1,003		Btu/cf
	Days Prod.		31	29	31	30	31	30	29	31	30	31	30	31	364	Days Prod.
Enerfin Resources	Mcf		9,435	8,797	9,181	9,234	10,120	8,849	8,806	9,413	9,149	9,065	9,160	9,037	110,246	Mcf
Columbia Co. 24-9-64	Cum. Mcf		1,525,064	1,533,861	1,543,042	1,552,276	1,562,396	1,571,245	1,580,051	1,589,464	1,598,613	1,607,678	1,616,838	1,625,875	1,625,875	Cum. Mcf
O&G 407	Tbg. Pres.															Tbg. Pres.
	Csg. Pres.		80	78	76	74	61	60	53	53	51	54	55	53		Csg. Pres.
	Therms		83,782	78,121	81,622	82,186	89,968	78,672	78,288	83,686	81,342	80,593	81,434	80,342	980,036	Therms
	Cum. Therms		13,485,139	13,563,260	13,644,882	13,727,068	13,817,036	13,895,708	13,973,996	14,057,682	14,139,024	14,219,617	14,301,051	14,381,393	14,381,393	Cum. Therms
	Btu/cf		888	888	889	889	889	889	889	889	889	889	889	889		Btu/cf
	Days Prod.		31	29	31	30	31	28	30	31	30	31	30	31	363	Days Prod.
Enerfin Resources	Mcf															Mcf
Columbia Co. 31-15-65	Cum. Mcf		714,250	714,250	714,250	714,250	714,250	714,250	714,250	714,250	714,250	714,250	714,250	714,250	714,250	Cum. Mcf
O&G 469	Tbg. Pres.															Tbg. Pres.
	Csg. Pres.															Csg. Pres.
	Therms															Therms
	Cum. Therms		6,676,700	6,676,700	6,676,700	6,676,700	6,676,700	6,676,700	6,676,700	6,676,700	6,676,700	6,676,700	6,676,700	6,676,700	6,676,700	Cum. Therms
	Btu/cf															Btu/cf
	Days Prod.															Days Prod.
Enerfin Resources	Mcf		131	139	127	177	126	143	93	261		263	36	97	1,593	Mcf
Columbia Co. 32-27-65 RD	Cum. Mcf		48,582	48,721	48,848	49,025	49,151	49,294	49,387	49,648	49,648	49,911	49,947	50,044	50,044	Cum. Mcf
O&G 502 RD	Tbg. Pres.															Tbg. Pres.
	Csg. Pres.		235	235	245	243	243	245	240	240		415	232	234		Csg. Pres.
	Therms		1,245	1,323	1,207	1,686	1,200	1,367	893	951		2,506	342	932	13,652	Therms
	Cum. Therms		461,925	463,248	464,455	466,141	467,341	468,708	469,601	470,552	470,552	473,058	473,400	474,332	474,332	Cum. Therms
	Btu/cf		948	948	948	951	951	951	951	951		951	952	952		Btu/cf
	Days Prod.		2	2	2	4	4	4	1	5		3	3	2	32	Days Prod.

		Production												Production		
		2000	Jan	Feb	Mar	Apr	May	Jun	Jul	Aug	Sep	Oct	Nov	Dec	Year Totals	2000
Enerfin Resources	Mcf			3,460	10,746	10,283	3,255					721	87	41	28,593	Mcf
Columbia Co.	Cum. Mcf			3,460	14,206	24,489	27,744	27,744	27,744	27,744	27,744	28,465	28,552	28,593	28,593	Cum. Mcf
41-6-65 RD	Tbg. Pres.															Tbg. Pres.
O & G 521 RD	Csg. Pres.		NEW	969	799	547	285					364	279	259		Csg. Pres.
	Therms			34,605	107,467	102,835	32,551					7,215	875	414	285,962	Therms
	Cum. Therms			34,605	142,072	244,907	277,458	277,458	277,458	277,458	277,458	284,673	285,548	285,962	285,962	Cum. Therms
	Btu/cf			1,000	1,000	1,000	1,000					1,000	1,000	1,000		Btu/cf
	Days Prod.			12	31	30	12					17	7	3	112	Days Prod.
Enerfin Resources	Mcf	20,191	18,619	20,353	20,379	19,739	18,197	2,053	13,034	12,649	11,734	6,501	1,311	164,760	Mcf	
Columbia Co. 42-8-54	Cum. Mcf	1,196,199	1,214,818	1,235,171	1,255,550	1,275,289	1,293,486	1,295,539	1,308,573	1,321,222	1,332,956	1,339,457	1,340,768	1,340,768	Cum. Mcf	
O&G 376	Tbg. Pres.															Tbg. Pres.
	Csg. Pres.	400	389	395	405	361	334	365	334	324	317	290	292			Csg. Pres.
	Therms	149,415	137,944	150,817	151,008	146,269	134,844	15,080	96,589	93,727	86,952	48,178	9,716	1,220,539	Therms	
	Cum. Therms	15,240,483	15,378,427	15,529,244	15,680,252	15,826,521	15,961,365	15,976,445	16,073,034	16,166,761	16,253,713	16,301,891	16,311,607	16,311,607	Cum. Therms	
	Btu/cf	740	741	741	741	741	741	741	741	741	741	741	741			Btu/cf
	Days Prod.	31	29	31	30	31	30	5	31	30	31	30	22	331	Days Prod.	
Enerfin Resources	Mcf	22,917	6,609	652										30,178	Mcf	
John Hancock 22-27-64	Cum. Mcf	264,448	271,057	271,709	271,709	271,709	271,709	271,709	271,709	271,709	271,709	271,709	271,709	271,709	Cum. Mcf	
O&G 514	Tbg. Pres.															Tbg. Pres.
	Csg. Pres.	860	442	369												Csg. Pres.
	Therms	197,089	56,884	5,621										259,594	Therms	
	Cum. Therms	2,274,314	2,331,198	2,336,819	2,336,819	2,336,819	2,336,819	2,336,819	2,336,819	2,336,819	2,336,819	2,336,819	2,336,819	2,336,819	Cum. Therms	
	Btu/cf	860	861	861												Btu/cf
	Days Prod.	31	28	9										68	Days Prod.	
Enerfin Resources	Mcf	10,921	11,353	13,471	12,167	14,663	12,421	10,673	12,011	12,248	13,434	11,901	13,431	148,694	Mcf	
John Hancock 32-27-64	Cum. Mcf	136,737	148,090	161,561	173,728	188,391	200,812	211,485	223,496	235,744	249,178	261,079	274,510	274,510	Cum. Mcf	
O&G 515	Tbg. Pres.															Tbg. Pres.
	Csg. Pres.	389	464	407	373	463	411	394	407	419	415	232	430			Csg. Pres.
	Therms	92,505	96,161	114,098	103,057	124,197	105,209	90,403	101,739	103,742	113,792	100,810	113,760	1,259,473	Therms	
	Cum. Therms	1,158,208	1,254,369	1,368,467	1,471,524	1,595,721	1,700,930	1,791,333	1,893,072	1,996,814	2,110,606	2,211,416	2,325,176	2,325,176	Cum. Therms	
	Btu/cf	847	847	847	847	847	847	847	847	847	847	847	847			Btu/cf
	Days Prod.	30	29	31	30	31	30	30	31	30	31	30	31	364	Days Prod.	
Enerfin Resources	Mcf	5,780	5,665	5,816	5,514	6,096	5,854	5,246	5,963	5,837	5,700	5,744	6,162	69,377	Mcf	
Longview Fibre	Cum. Mcf	1,301,910	1,307,575	1,313,391	1,318,905	1,325,001	1,330,855	1,336,101	1,342,064	1,347,901	1,353,601	1,359,345	1,365,507	1,365,507	Cum. Mcf	
12A-33-75	Tbg. Pres.	121	122	133	126	112	111	110	109	105	109	88	84			Tbg. Pres.
O&G 474	Csg. Pres.	181	183	193	198	181	180	183	180	178	188	180	177			Csg. Pres.
	Therms	57,863	56,746	58,282	55,258	61,086	58,668	52,577	59,755	58,493	57,123	57,559	61,745	695,155	Therms	
	Cum. Therms	10,947,062	11,003,808	11,062,090	11,117,348	11,178,434	11,237,102	11,289,679	11,349,434	11,407,927	11,465,050	11,522,609	11,584,354	11,584,354	Cum. Therms	
	Btu/cf	1,001	1,002	1,002	1,002	1,002	1,002	1,002	1,002	1,002	1,002	1,002	1,002			Btu/cf
	Days Prod.	31	29	31	30	31	30	29	31	30	31	30	31	364	Days Prod.	

		Production 2000												Production 2000	
		Jan	Feb	Mar	Apr	May	Jun	Jul	Aug	Sep	Oct	Nov	Dec	Year Totals	
Enerfin Resources	Mcf	374	395	729	815	689	616	412	488	581	518	354	520	6,491	Mcf
Longview Fibre	Cum. Mcf	463,294	463,689	464,418	465,233	465,922	466,538	466,950	467,438	468,019	468,537	468,891	469,411	469,411	Cum. Mcf
32-20-65	Tbg. Pres.	245	239	142	86	102	81	94	93	84	99	88	77		Tbg. Pres.
O&G 412	Csg. Pres.	323	343	226	194	200	188	253	250	220	239	327	201		Csg. Pres.
	Therms	3,716	3,927	7,240	8,097	6,835	6,114	4,086	4,848	5,763	5,143	3,520	5,161	64,450	Therms
	Cum. Therms	4,582,731	4,586,658	4,593,898	4,601,995	4,608,830	4,614,944	4,619,030	4,623,878	4,629,641	4,634,784	4,638,304	4,643,465	4,643,465	Cum. Therms
	Btu/cf	992	992	992	992	992	992	992	992	992	992	992	992		Btu/cf
	Days Prod.	31	29	31	30	31	30	28	31	30	31	30	31	363	Days Prod.
Northwest Natural	Mcf	778	919	1,078	1,089	957	857	831	635	734	966	833	793	10,470	Mcf
Columbia Co. 13-34-75	Cum. Mcf	4,074,593	4,075,512	4,076,590	4,077,679	4,078,636	4,079,493	4,080,324	4,080,959	4,081,693	4,082,659	4,083,492	4,084,285	4,084,285	Cum. Mcf
O&G 225	Tbg. Pres.	141	142	140	140	137	133	137	140	139	136	129	129		Tbg. Pres.
	Csg. Pres.	141	142	141	140	137	135	138	140	140	136	133	132		Csg. Pres.
	Therms	7,675	9,067	10,633	10,744	9,445	8,452	8,206	6,278	7,239	9,524	8,214	7,821	103,298	Therms
	Cum. Therms	39,188,359	39,197,426	39,208,059	39,218,803	39,228,248	39,236,700	39,244,906	39,251,184	39,258,423	39,267,947	39,276,161	39,283,982	39,283,982	Cum. Therms
	Btu/cf	986	986	986	986	986	986	986	986	986	986	986	986		Btu/cf
	Days Prod.	24	29	31	30	31	30	31	22	23	31	30	31	343	Days Prod.
Northwest Natural	Mcf	1,250	1,340	1,246	1,206	1,359	1,188	1,192	1,260	1,256	1,534	1,025	1,256	15,112	Mcf
Columbia Co. 43-33-75	Cum. Mcf	1,545,555	1,546,895	1,548,141	1,549,347	1,550,706	1,551,894	1,553,086	1,554,346	1,555,602	1,557,136	1,558,161	1,559,417	1,559,417	Cum. Mcf
O&G 470	Tbg. Pres.	140	139	139	139	137	139	139	139	139	140	140	141		Tbg. Pres.
	Csg. Pres.	141	140	139	139	137	139	139	140	139	140	140	141		Csg. Pres.
	Therms	12,350	13,252	12,335	11,936	13,444	11,760	11,804	12,478	12,431	15,171	10,143	12,426	149,530	Therms
	Cum. Therms	15,275,802	15,289,054	15,301,389	15,313,325	15,326,769	15,338,529	15,350,333	15,362,811	15,375,242	15,390,413	15,400,556	15,412,982	15,412,982	Cum. Therms
	Btu/cf	988	989	989	989	989	989	989	989	989	989	989	989		Btu/cf
	Days Prod.	31	29	31	30	31	30	30	31	30	31	26	31	361	Days Prod.
Northwest Natural	Mcf	292	270	290	294	319	286	48	295	267	256	226	252	3,095	Mcf
Columbia Co. 44-27-65	Cum. Mcf	738,266	738,536	738,826	739,120	739,439	739,725	739,773	740,068	740,335	740,591	740,817	741,069	741,069	Cum. Mcf
O&G 406	Tbg. Pres.														Tbg. Pres.
	Csg. Pres.	236	234	241	239	236	235	283	232	231	232	232	231		Csg. Pres.
	Therms	2,717	2,509	2,695	2,738	2,972	2,665	449	2,747	2,488	2,383	2,102	2,349	28,814	Therms
	Cum. Therms	6,686,614	6,689,123	6,691,818	6,694,556	6,697,528	6,700,193	6,700,642	6,703,389	6,705,877	6,708,260	6,710,362	6,712,711	6,712,711	Cum. Therms
	Btu/cf	930	930	930	930	930	930	930	930	930	930	930	930		Btu/cf
	Days Prod.	31	29	31	30	31	30	6	31	30	31	30	31	341	Days Prod.
Northwest Natural	Mcf	1,906	1,999	2,221	2,289	2,409	2,269	391	1,543	2,244	2,338	2,926	1,710	24,245	Mcf
Longview Fibre	Cum. Mcf	1,293,804	1,295,803	1,298,024	1,300,313	1,302,722	1,304,991	1,305,382	1,306,925	1,309,169	1,311,507	1,314,433	1,316,143	1,316,143	Cum. Mcf
12B-35-65	Tbg. Pres.	216	216	216	215	215	214	215	215	214	213	212	212		Tbg. Pres.
O&G 476	Csg. Pres.	217	217	216	215	215	215	215	215	214	213	213	213		Csg. Pres.
	Therms	17,231	18,072	20,087	20,699	21,782	20,515	3,540	13,949	20,287	21,153	18,340	15,475	211,130	Therms
	Cum. Therms	11,929,289	11,947,361	11,967,448	11,988,147	12,009,929	12,030,444	12,033,984	12,047,933	12,068,220	12,089,373	12,107,713	12,123,188	12,123,188	Cum. Therms
	Btu/cf	904	904	904	904	904	904	904	904	904	904	905	905		Btu/cf
	Days Prod.	31	29	31	30	31	30	6	21	30	31	30	27	327	Days Prod.

TOTAL MCF FOR YEAR 1,596,159
TOTAL CUM. MCF TO DATE, MIST GAS FIELD 88,634,152